

Herchimer Avenue Reconstruction

Public Information Centre
November 22, 2016

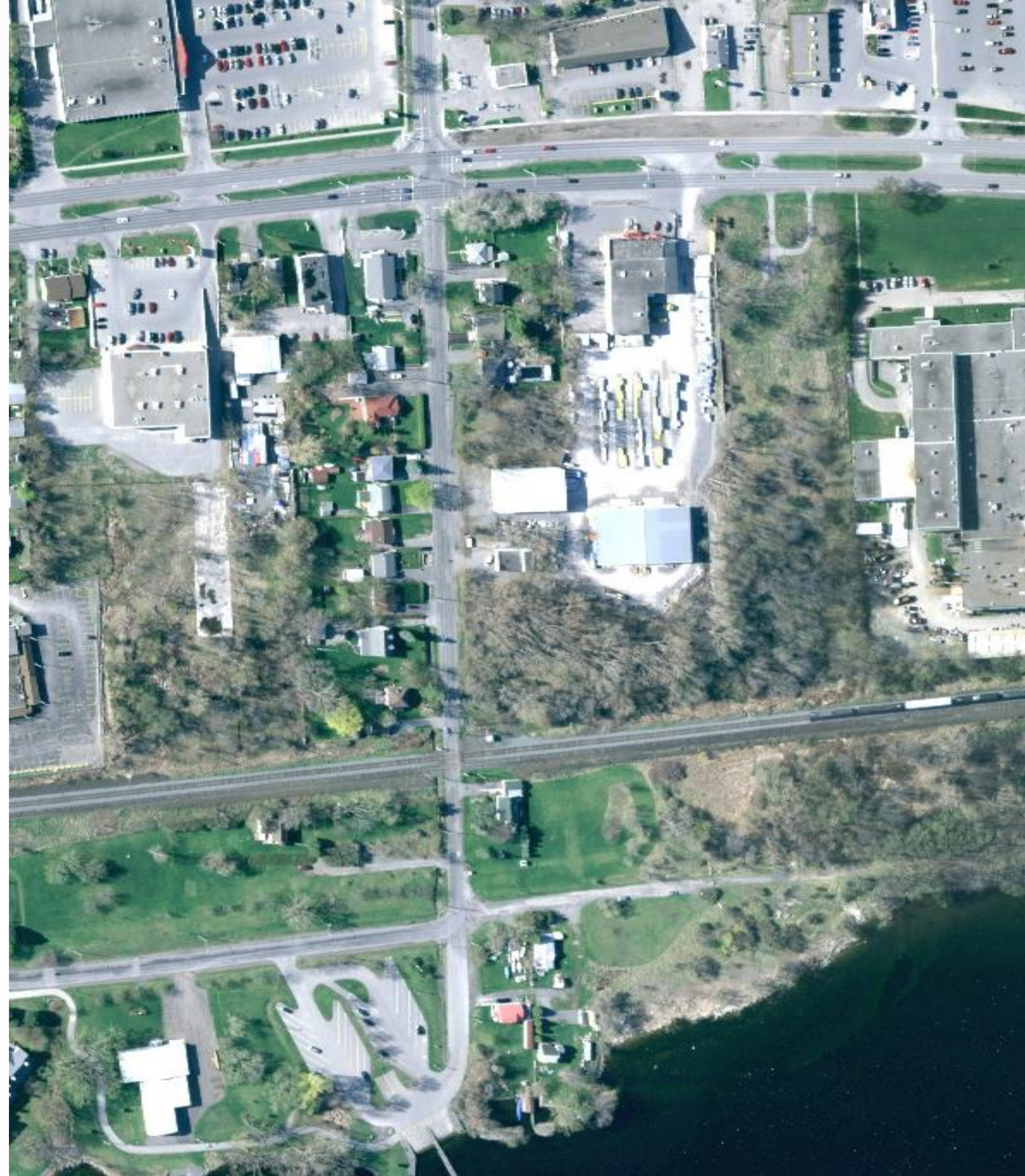

WELCOME

WE'RE BUILDING A BETTER BELLEVILLE FOR YOU

BUILDBELLEVILLE.CA



PROJECT INFORMATION

- **Herchimer Avenue will be reconstructed from Dundas Street East to the boat launch, with new asphalt paving and concrete curb and gutter.**
- **A new asphalt bike & pedestrian path will be constructed on the east side of the road.**
- **A new northbound left turn lane will be added on Herchimer Avenue.**
- **New storm sewers will be installed, and the existing open ditches will be infilled.**
- **The existing watermain will be replaced, complete with new services connected to the existing services at property line.**
- **The existing sanitary sewer will be replaced, complete with new services connected to the existing laterals at property line.**

WE'RE BUILDING A BETTER
BELLEVILLE FOR YOU

BUILDBELLEVILLE.CA



ESTIMATED PROJECT COSTS

→ Roadwork	\$1,500,000
→ Storm Sewer Construction	\$725,000
→ Watermain Replacement	\$250,000
→ Sanitary Sewer Replacement	\$250,000
→ Railway Crossing & Upgrades	\$500,000
→ Utility Relocation (Hydro, Bell, etc.)	\$400,000
→ Total	\$3,625,000

WE'RE BUILDING A BETTER BELLEVILLE FOR YOU BUILDHELLEVILLE.CA



NEXT TASKS

- Public Information Centre: November 2016**
- Finalize Design**
- Utility Coordination**
- Hydro Relocations**
- Ministry of the Environment & Climate Change Approval
(Approval submission made September 2016)**
- Canadian Pacific Railway Approval
(Approval submission made October 2016)**
- Transport Canada Approval**
- Issue Tender**
- Construction**

WE'RE BUILDING A BETTER
BELLEVILLE FOR YOU

BUILDBELLEVILLE.CA



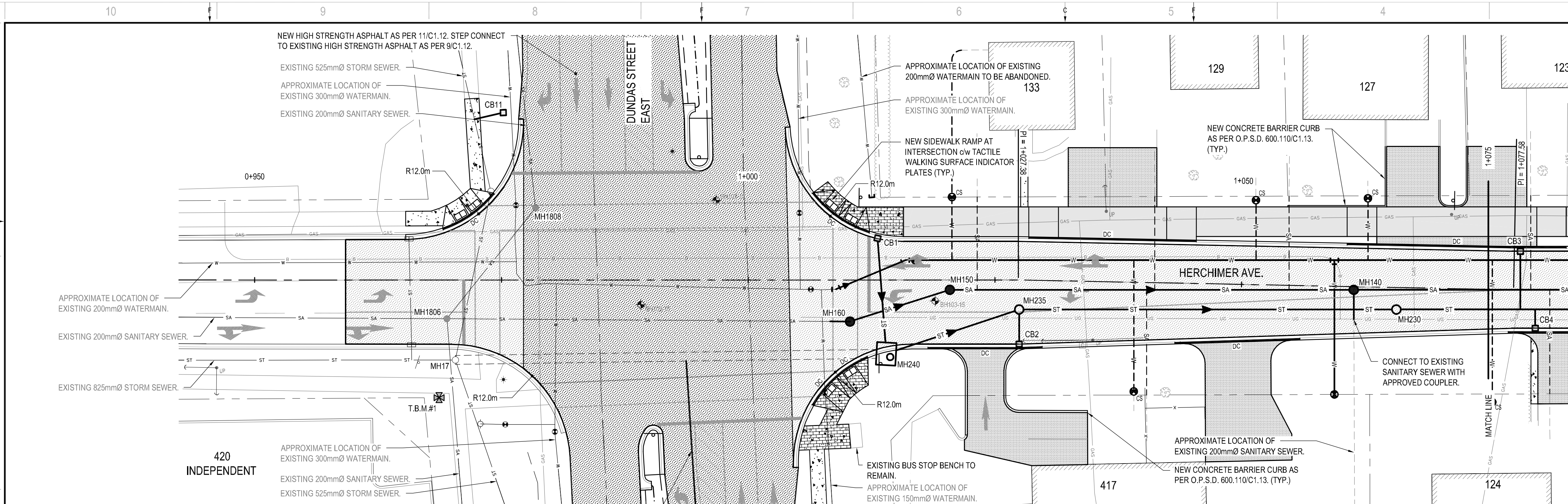

CB No.	STATION	TOP OF GRATE (m)	INVERT (m)	INVERT AT MAIN (m)	SUMP (m)	LEAD (mm)	SLOPE (%)	SIZE (mm)	LEAD LENGTH (m)
CB1	1+013.12	89.12	SW 87.84	87.52	87.24	300	3.0%	600X600	10.6
CB2	1+027.59	88.38	E 87.10	87.01	86.50	300	3.0%	600X600	3.0

DI No.	STATION	TOP OF GRATE	INVERT	SUMP	LEAD	SLOPE	SIZE	LENGTH
DI60	0+998.86	0.00 3H:1V	E -1.06	-1.68	250	-1.2%	600X600	79.9

STATION	INVERT (m)	SIZE (mm)	LENGTH (m)	NOTE
1+010	88.44	200	100	NEW SAN MH NO. MH160
1+014	88.15	150	100	NEW STIM MH NO. MH240
1+020	88.84	200	100	NEW SAN MH NO. MH150
1+023	88.46	200	100	NEW STIM MH NO. MH235
1+041	88.15	200	100	NEW SAN MH NO. MH140
1+046	88.15	200	100	NEW STIM MH NO. MH230

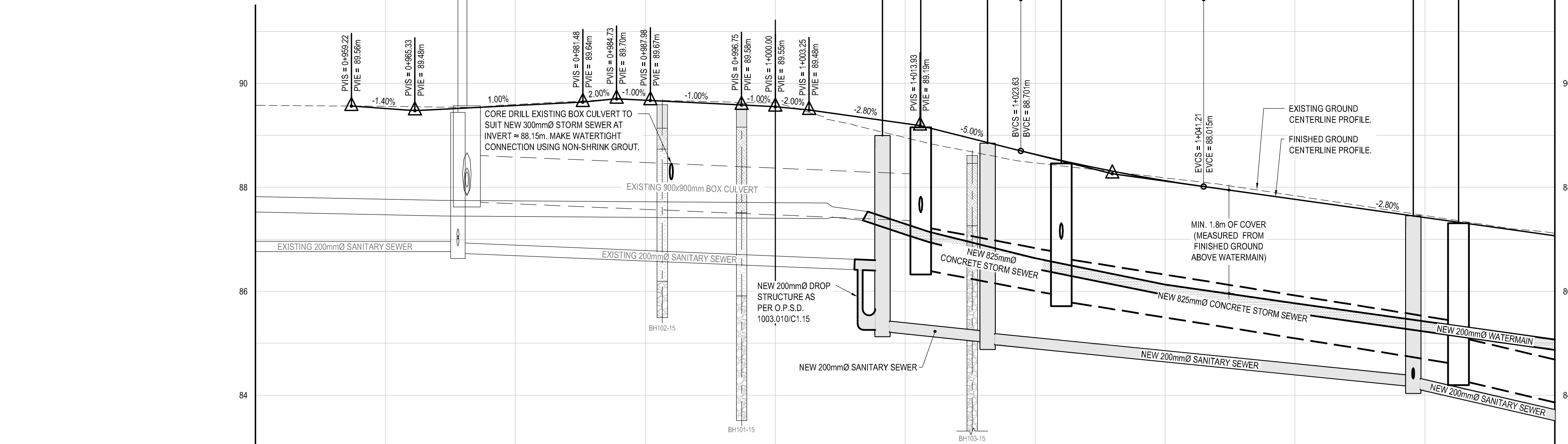

STA.	ELEVATION
1+023.83	88.701
1+025	88.63
1+030	88.41
1+035	88.21
1+040	88.05
1+041.21	88.015

- NOTES:**
- CONTRACTOR TO VERIFY LOCATION OF ALL BURIED SERVICES PRIOR TO START OF CONSTRUCTION
 - TOPOGRAPHIC INFORMATION PROVIDED BY THE CITY OF BELLEVILLE AND BY LESLIE M. HIGGINSON SURVEYING LTD.
 - ELEVATIONS SHOWN ON THIS PLAN ARE GEODETIC AND HAVE BEEN DERIVED BY GPS.
 - ALL DISTURBED AREAS TO BE REINSTATED USING 150mm OF TOPSOIL AND SEED UNLESS OTHERWISE NOTED.

- LEGEND:**
- EXISTING PROPERTY LINE
 - NEW EDGE OF PAVEMENT
 - EXISTING EDGE OF PAVEMENT
 - NEW CURB
 - NEW DEPRESS CURB
 - EXISTING CURB
 - NEW EDGE OF GRANULARS
 - EXISTING BOTTOM OF SLOPE
 - EXISTING TOP OF SLOPE
 - EXISTING FENCE
 - NEW SANITARY SEWER
 - EXISTING SANITARY SEWER
 - NEW SANITARY SERVICE
 - NEW STORM SEWER
 - EXISTING STORM SEWER
 - NEW STORM SERVICE
 - NEW PERFORATED PIPE
 - NEW WATERMAIN
 - EXISTING WATERMAIN
 - NEW WATER SERVICE
 - NEW SEWER INSULATION AS PER 3/C1.12
 - NEW SANITARY MANHOLE
 - EXISTING SANITARY MANHOLE
 - NEW STORM MANHOLE
 - EXISTING STORM MANHOLE
 - NEW CATCH BASIN MANHOLE
 - NEW CATCH BASIN
 - EXISTING CATCH BASIN
 - NEW HYDRANT
 - EXISTING HYDRANT
 - NEW VALVE
 - EXISTING VALVE
 - NEW BLOW-OFF
 - EXISTING BELL LINE
 - EXISTING GAS LINE
 - EXISTING UNDERGROUND SERVICE
 - EXISTING OVERHEAD SERVICE
 - EXISTING UTILITY POLE
 - EXISTING BELL MANHOLE
 - EXISTING BELL PEDESTAL
 - EXISTING CABLE PEDESTAL
 - EXISTING GAS VALVE
 - EXISTING BOLLARD
 - SITE TEMPORARY BENCH MARK BOREHOLE
 - NEW PAINT LINES
 - NEW SIDEWALK AS PER O.P.S.D. 310.010/C1.13 OR 310.020/C1.13
 - NEW ASPHALT BIKE PATH AS PER DETAIL 1&2/C1.12
 - NEW ASPHALT AS PER DETAIL 1&2/C1.12
 - NEW HIGH STRENGTH ASPHALT AS PER DETAIL 11/C1.12
 - NEW ASPHALT DRIVEWAY AS PER DETAIL 6/C1.12
 - NEW GRANULAR DRIVEWAY AS PER DETAIL 7/C1.12
 - NEW STAMPED CONCRETE

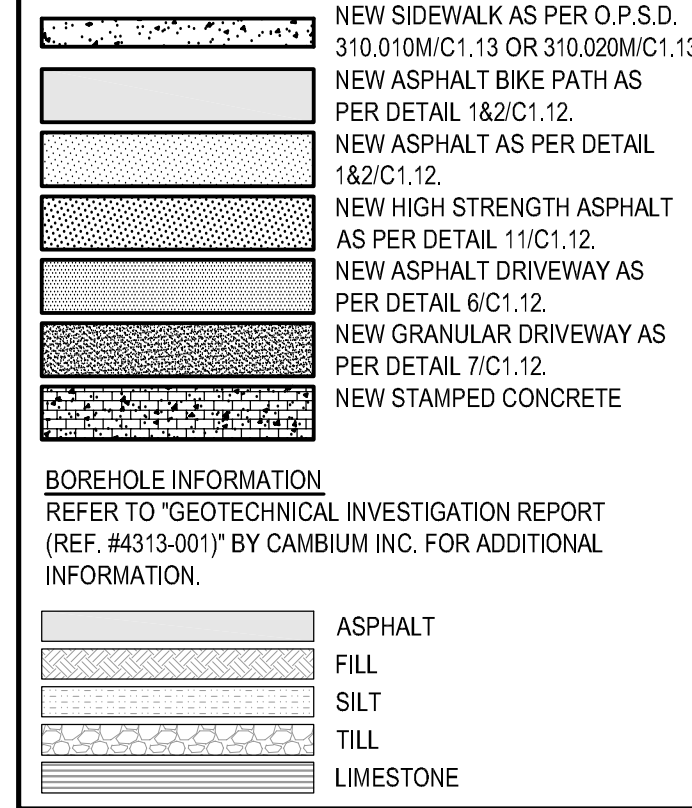
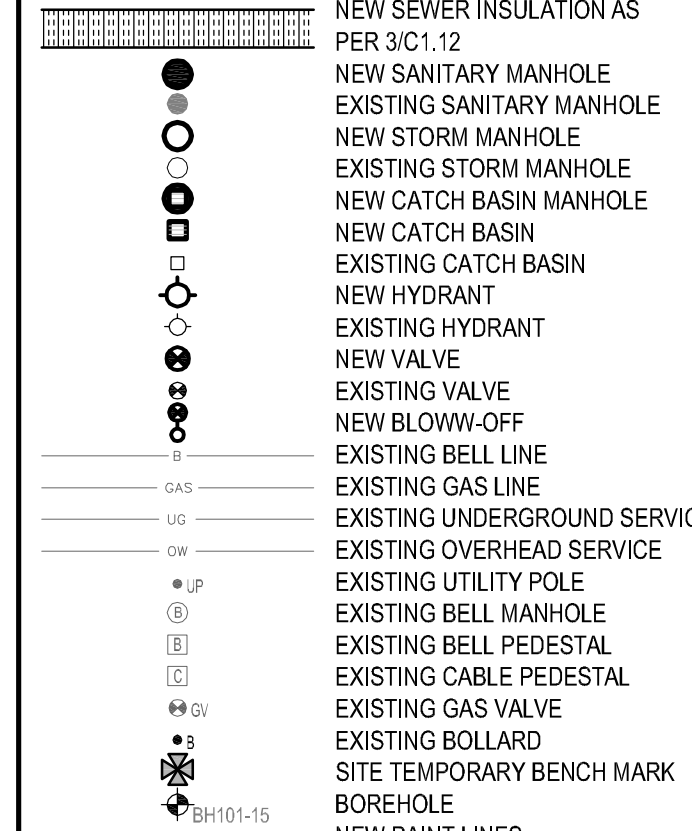

T.B.M. #	ELEVATION (m)	DESCRIPTION
T.B.M.#1	89.66	TOP OF IRON BAR

1345 ROSEMOUNT AVENUE
CORNWALL, ONTARIO
CANADA K6J 3E5
PHONE: 613-833-5902 FAX: 613-836-0335
WWW.WSPGROUP.COM

BELLEVILLE
CITY OF BELLEVILLE

HERCHIMER AVE. RECONSTRUCTION

CLIENT REF. #:

PROJECT:

KEY PLAN:

ISSUED FOR - REVISION:

NO.	DATE	DESCRIPTION
3	2016/06/24	ISSUED FOR 90% DESIGN REVIEW
2	2016/03/16	ISSUED FOR 60% DESIGN REVIEW
1	2015/09/10	ISSUED FOR 30% DESIGN REVIEW

PROJECT NO: 151-05368-00 DATE: 2016/06/24

ORIGINAL SCALE: H:1:250, V:1:50 IF THIS BAR IS NOT 25mm LONG, ADJUST YOUR PLOTTING SCALE.

DESIGNED BY: F.L.

DRAWN BY: K.B.W.

CHECKED BY: J.E.

DISCIPLINE: CIVIL

TITLE: PLAN AND PROFILE OF HERCHIMER AVE. FROM STA 0+925 TO STA 1+075

SHEET NUMBER: C1.1

SHEET # OF: 1 OF 1

ISSUE: ISSUED FOR 90% DESIGN REVIEW

DATE OF: 2016/06/24

REV # 0

M:\2016\151-05368-00 - Herchimer Ave. Reconstruction\0_Dwg\2_Civil\151-05368-00-C1-1.dwg Jun 24, 2016 6:46am BY: (km.wah)

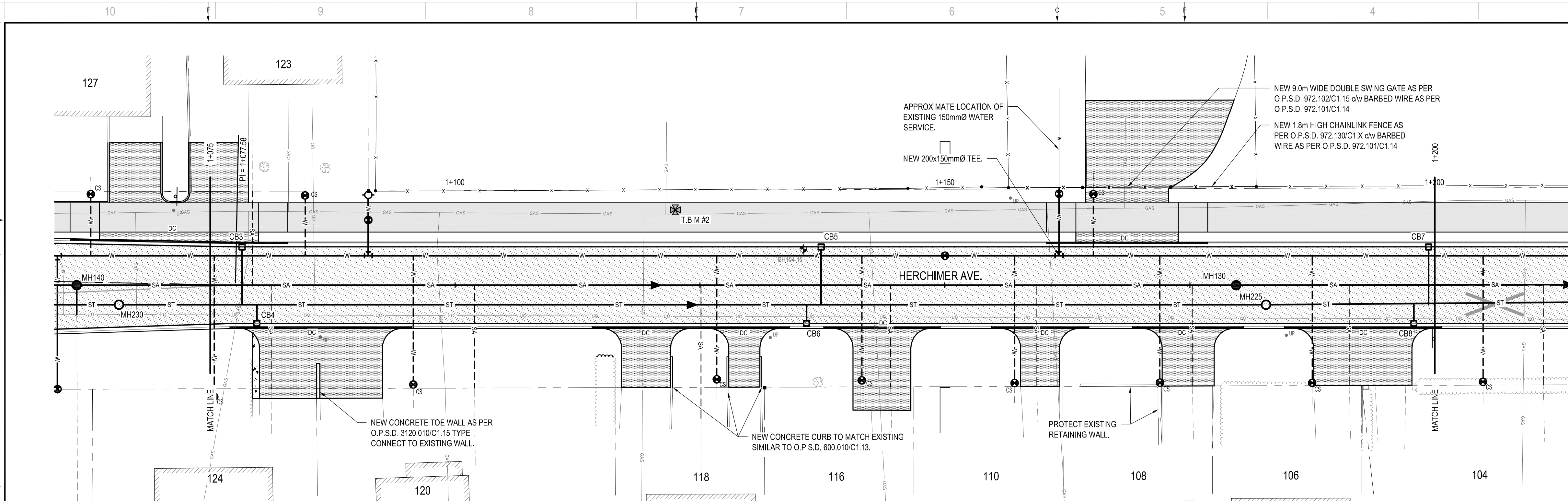

SCHEDULE OF CATCH BASIN									SCHEDULE OF CATCH BASIN										
CB No.	STATION	TOP OF GRATE (m)	INVERT (m)	INVERT AT MAIN (m)	SUMP (m)	LEAD (mm)	SLOPE (%)	SIZE	LEAD LENGTH (m)	CB No.	STATION	TOP OF GRATE (m)	INVERT (m)	INVERT AT MAIN (m)	SUMP (m)	LEAD (mm)	SLOPE (%)	SIZE	LEAD LENGTH (m)
CB3	1+078.26	86.90	W 85.62	84.60	85.02	300	17.3%	600X600	5.9	CB6	1+135.87	84.11	E 82.83	* 82.64	82.23	300	10.0%	600X600	1.9
CB4	1+079.76	86.85	E 85.57	* 85.38	84.97	300	10.0%	600X600	1.9	CB7	1+199.37	80.51	W 79.23	78.92	78.63	300	5.3%	600X600	5.9
CB5	1+137.37	84.02	W 82.74	81.80	82.14	300	15.9%	600X600	5.9	CB8	1+197.87	80.58	E 79.30	* 79.11	78.70	300	10.0%	600X600	1.9

VERTICAL CURVE No.2
 A = -2.20%
 K = 10.000
 L = 21.98m

VERTICAL CURVE No.2

STA.	ELEVATION
1+076.41	87.028
1+080	86.92
1+085	86.75
1+090	86.57
1+095	86.33
1+098.40	86.171

VERTICAL CURVE No.3

STA.	ELEVATION
1+199.86	80.569
1+200	80.56

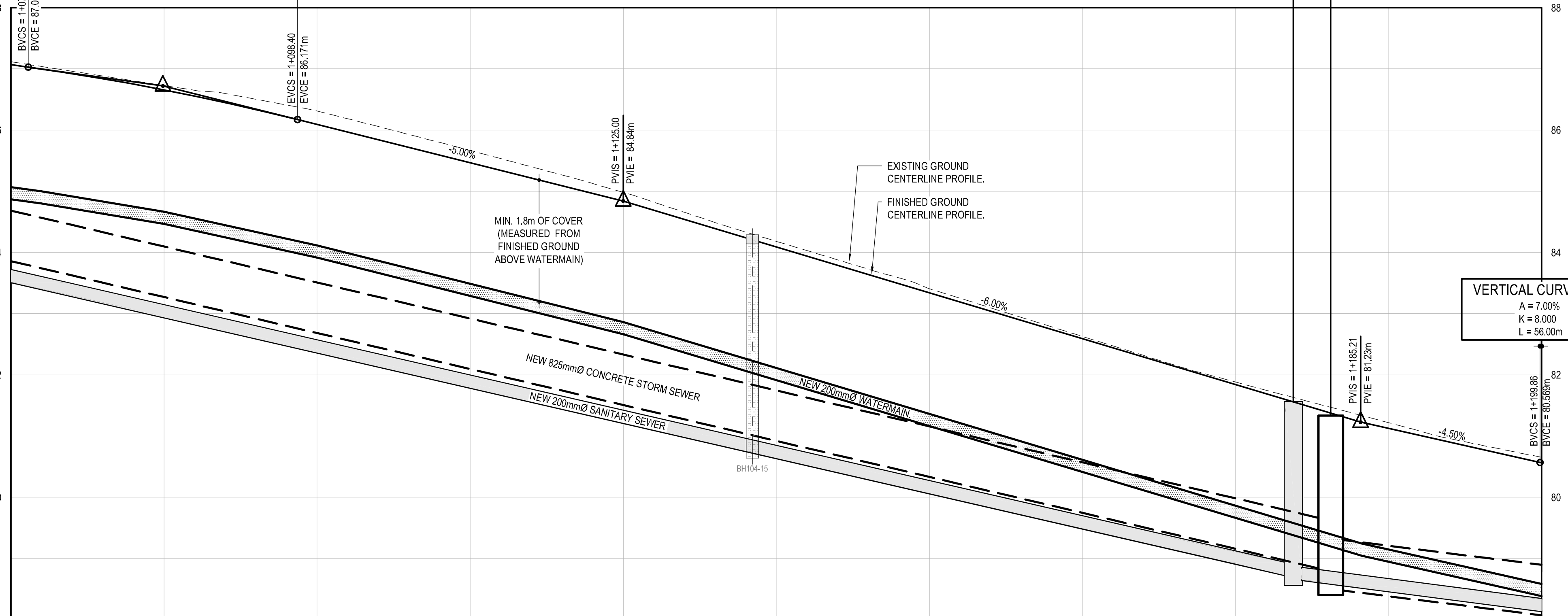

STATION	CENTERLINE GRADE FINISHED EXISTING	TOP OF WATERMAIN	SANITARY SEWER INVERT	STORM SEWER INVERT	STATION	CENTERLINE GRADE FINISHED EXISTING	TOP OF WATERMAIN	SANITARY SEWER INVERT	STORM SEWER INVERT
1+100	87.07 / 87.11	85.07	84.14	84.29	1+175	81.58 / 81.62	79.86	78.90	78.93
1+150	85.34 / 85.41	81.36	79.20 / 79.27	78.79 / 78.80	1+200	80.56 / 80.62	78.59	76.90	76.93

- NOTES:**
- CONTRACTOR TO VERIFY LOCATION OF ALL BURIED SERVICES PRIOR TO START OF CONSTRUCTION
 - TOPOGRAPHIC INFORMATION PROVIDED BY THE CITY OF BELLEVILLE AND BY LESLIE M. HIGGINSON SURVEYING LTD.
 - ELEVATIONS SHOWN ON THIS PLAN ARE GEODETIC AND HAVE BEEN DERIVED BY GPS.
 - ALL DISTURBED AREAS TO BE REINSTATED USING 150mm OF TOPSOIL AND SEED UNLESS OTHERWISE NOTED.

- LEGEND:**
- EXISTING PROPERTY LINE
 - NEW EDGE OF PAVEMENT
 - EXISTING EDGE OF PAVEMENT
 - NEW CURB
 - NEW DEPRESS CURB
 - EXISTING CURB
 - NEW EDGE OF GRANULARS
 - EXISTING BOTTOM OF SLOPE
 - EXISTING TOP OF SLOPE
 - EXISTING FENCE
 - NEW SANITARY SEWER
 - EXISTING SANITARY SEWER
 - NEW SANITARY SERVICE
 - NEW STORM SEWER
 - EXISTING STORM SEWER
 - NEW STORM SERVICE
 - NEW PERFORATED PIPE
 - NEW WATERMAIN
 - EXISTING WATERMAIN
 - NEW WATER SERVICE
 - NEW SEWER INSULATION AS PER 3/C1.12
 - NEW SANITARY MANHOLE
 - EXISTING SANITARY MANHOLE
 - NEW STORM MANHOLE
 - EXISTING STORM MANHOLE
 - NEW CATCH BASIN MANHOLE
 - NEW CATCH BASIN
 - EXISTING CATCH BASIN
 - NEW HYDRANT
 - EXISTING HYDRANT
 - NEW VALVE
 - EXISTING VALVE
 - NEW BLOW-OFF
 - EXISTING BELL LINE
 - EXISTING GAS LINE
 - EXISTING UNDERGROUND SERVICE
 - EXISTING OVERHEAD SERVICE
 - EXISTING UTILITY POLE
 - EXISTING BELL MANHOLE
 - EXISTING BELL PEDESTAL
 - EXISTING CABLE PEDESTAL
 - EXISTING GAS VALVE
 - EXISTING BOLLARD
 - SITE TEMPORARY BENCH MARK BOREHOLE
 - NEW PAINT LINES
 - NEW SIDEWALK AS PER O.P.S.D. 310.010/C1.13 OR 310.020/C1.13
 - NEW ASPHALT BIKE PATH AS PER DETAIL 1&2/C1.12
 - NEW ASPHALT AS PER DETAIL 1&2/C1.12
 - NEW HIGH STRENGTH ASPHALT AS PER DETAIL 11/C1.12
 - NEW ASPHALT DRIVEWAY AS PER DETAIL 6/C1.12
 - NEW GRANULAR DRIVEWAY AS PER DETAIL 7/C1.12
 - NEW STAMPED CONCRETE

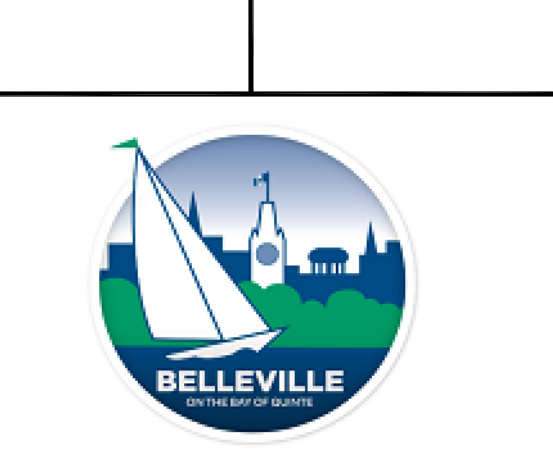
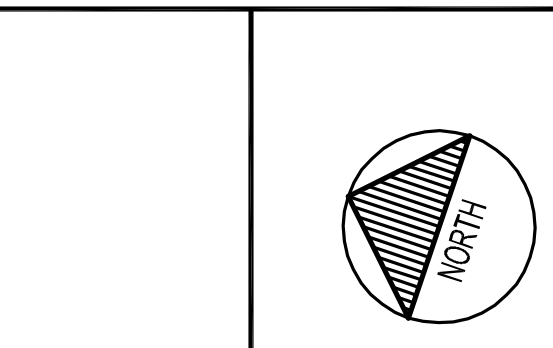
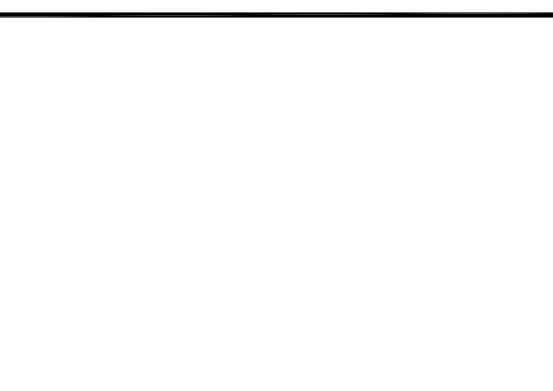
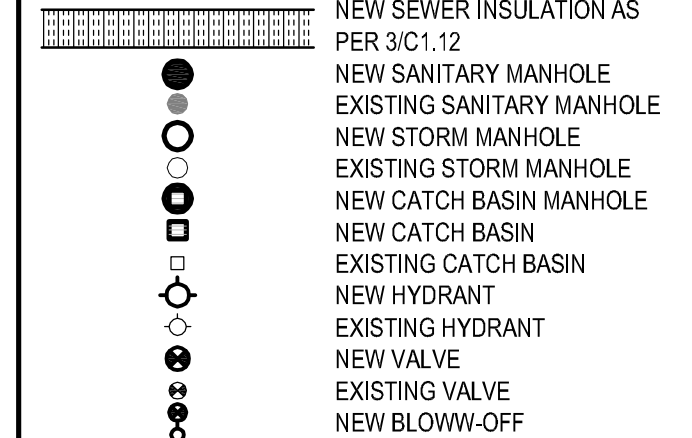

HERCHIMER AVE. RECONSTRUCTION

DISCLAIMER: THIS DRAWING AND DESIGN IS COPYRIGHT PROTECTED WHICH SHALL NOT BE USED, REPRODUCED OR PUBLISHED WITHOUT WRITTEN PERMISSION BY WSP. THE CONTRACTOR SHALL CHECK AND VERIFY ALL DIMENSIONS AND UTILITY LOCATIONS AND REPORT ALL ERRORS AND OMISSIONS PRIOR TO COMMENCING WORK. THIS DRAWING IS NOT TO BE SCALED.

BOREHOLE INFORMATION
 REFER TO "GEOTECHNICAL INVESTIGATION REPORT (REF. #4313-001)" BY CAMBIUM INC. FOR ADDITIONAL INFORMATION.

ASPHALT	FILL	SILT	TILL	LIMESTONE
[Symbol]	[Symbol]	[Symbol]	[Symbol]	[Symbol]

TEMPORARY BENCH MARKS

T.B.M. #	ELEVATION (m)	DESCRIPTION
T.B.M.#2	85.13	NAIL IN ASPHALT

ISSUE FOR - REVISION	NO.	DATE	DESCRIPTION
ISSUED FOR 90% DESIGN REVIEW	3	2016/06/24	
ISSUED FOR 60% DESIGN REVIEW	2	2016/03/16	
ISSUED FOR 30% DESIGN REVIEW	1	2015/09/10	

PROJECT NO.	DATE
151-05368-00	2016/06/24

ORIGINAL SCALE: H:1:250, V:1:50
 DESIGNED BY: F.L.
 DRAWN BY: K.B.W.
 CHECKED BY: J.E.
 DISCIPLINE: CIVIL

TITLE: **PLAN AND PROFILE OF HERCHIMER AVE. FROM STA 1+075 TO STA 1+200**

SHEET NUMBER: **C1.2**

ISSUE: **ISSUED FOR 90% DESIGN REVIEW**

DATE OF: 2016/06/24

REV # **0**

- NOTES:**
- CONTRACTOR TO VERIFY LOCATION OF ALL BURIED SERVICES PRIOR TO START OF CONSTRUCTION
 - TOPOGRAPHIC INFORMATION PROVIDED BY THE CITY OF BELLEVILLE AND BY LESLIE M. HIGGINSON SURVEYING LTD.
 - ELEVATIONS SHOWN ON THIS PLAN ARE GEODETIC AND HAVE BEEN DERIVED BY GPS.
 - ALL DISTURBED AREAS TO BE REINSTATED USING 150mm OF TOPSOIL AND SEED UNLESS OTHERWISE NOTED.

- LEGEND:**
- EXISTING PROPERTY LINE
 - NEW EDGE OF PAVEMENT
 - EXISTING EDGE OF PAVEMENT
 - NEW CURB
 - EXISTING CURB
 - NEW DEPRESS CURB
 - NEW EDGE OF GRANULARS
 - EXISTING BOTTOM OF SLOPE
 - EXISTING TOP OF SLOPE
 - EXISTING FENCE
 - NEW SANITARY SEWER
 - EXISTING SANITARY SEWER
 - NEW SANITARY SERVICE
 - NEW STORM SEWER
 - EXISTING STORM SEWER
 - NEW STORM SERVICE
 - NEW PERFORATED PIPE
 - NEW WATERMAIN
 - EXISTING WATERMAIN
 - NEW WATER SERVICE
 - NEW SEWER INSULATION AS PER 3/C1.12
 - NEW SANITARY MANHOLE
 - EXISTING SANITARY MANHOLE
 - NEW STORM MANHOLE
 - EXISTING STORM MANHOLE
 - NEW CATCH BASIN MANHOLE
 - EXISTING CATCH BASIN
 - NEW HYDRANT
 - EXISTING HYDRANT
 - NEW VALVE
 - EXISTING VALVE
 - NEW BLOW-OFF
 - EXISTING BELL LINE
 - EXISTING GAS LINE
 - EXISTING UNDERGROUND SERVICE
 - EXISTING OVERHEAD SERVICE
 - EXISTING UTILITY POLE
 - EXISTING BELL MANHOLE
 - EXISTING BELL PEDESTAL
 - EXISTING CABLE PEDESTAL
 - EXISTING GAS VALVE
 - EXISTING BOLLARD
 - SITE TEMPORARY BENCH MARK BOREHOLE
 - NEW PAINT LINES
 - NEW SIDEWALK AS PER O.P.S.D. 310.010(C)1.13 OR 310.020(C)1.13
 - NEW ASPHALT BIKE PATH AS PER DETAIL 1&2/C1.12
 - NEW ASPHALT AS PER DETAIL 1&2/C1.12
 - NEW HIGH STRENGTH ASPHALT AS PER DETAIL 11/C1.12
 - NEW ASPHALT DRIVEWAY AS PER DETAIL 6/C1.12
 - NEW GRANULAR DRIVEWAY AS PER DETAIL 7/C1.12
 - NEW STAMPED CONCRETE

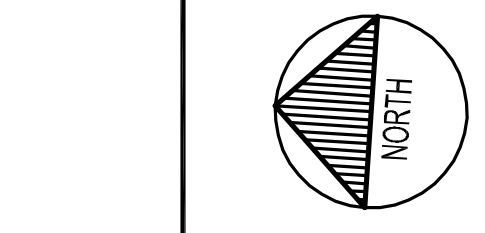

HERCHIMER AVE. RECONSTRUCTION

DISCLAIMER: THIS DRAWING AND DESIGN IS COPYRIGHT PROTECTED WHICH SHALL NOT BE USED, REPRODUCED OR PRESENTED WITHOUT WRITTEN PERMISSION BY WSP. THE CONTRACTOR SHALL CHECK AND VERIFY ALL DIMENSIONS AND UTILITY LOCATIONS AND REPORT ALL ERRORS AND OMISSIONS PRIOR TO COMMENCING WORK. THIS DRAWING IS NOT TO BE SCALED.

BOREHOLE INFORMATION REFER TO "GEOTECHNICAL INVESTIGATION REPORT (REF. #4313-001)" BY CAMBIUM INC. FOR ADDITIONAL INFORMATION.

TEMPORARY BENCH MARKS

T.B.M. #	ELEVATION (m)	DESCRIPTION
T.B.M.#3	79.58	NAIL IN ASPHALT
T.B.M.#4	77.06	SPIKE IN GROUND

ISSUE FOR - REVISION	NO.	DATE	DESCRIPTION
	3	2016/06/24	ISSUED FOR 90% DESIGN REVIEW
	2	2016/03/16	ISSUED FOR 60% DESIGN REVIEW
	1	2015/09/10	ISSUED FOR 30% DESIGN REVIEW

PROJECT NO:	151-05368-00	DATE:	2016/06/24
ORIGINAL SCALE:	H:1:250, V:1:50	IF THIS BAR IS NOT 25mm LONG, ADJUST YOUR PLOTTING SCALE.	
DESIGNED BY:	F.L.		
DRAWN BY:	K.B.W.		
CHECKED BY:	J.E.		
DISCIPLINE:	CIVIL		

TITLE:	PLAN AND PROFILE OF HERCHIMER AVE. FROM STA 1+200 TO STA 1+325		
SHEET NUMBER:	C1.3		
ISSUE FOR:	ISSUED FOR 90% DESIGN REVIEW		
DATE OF:	2016/06/24		
REV #	0		

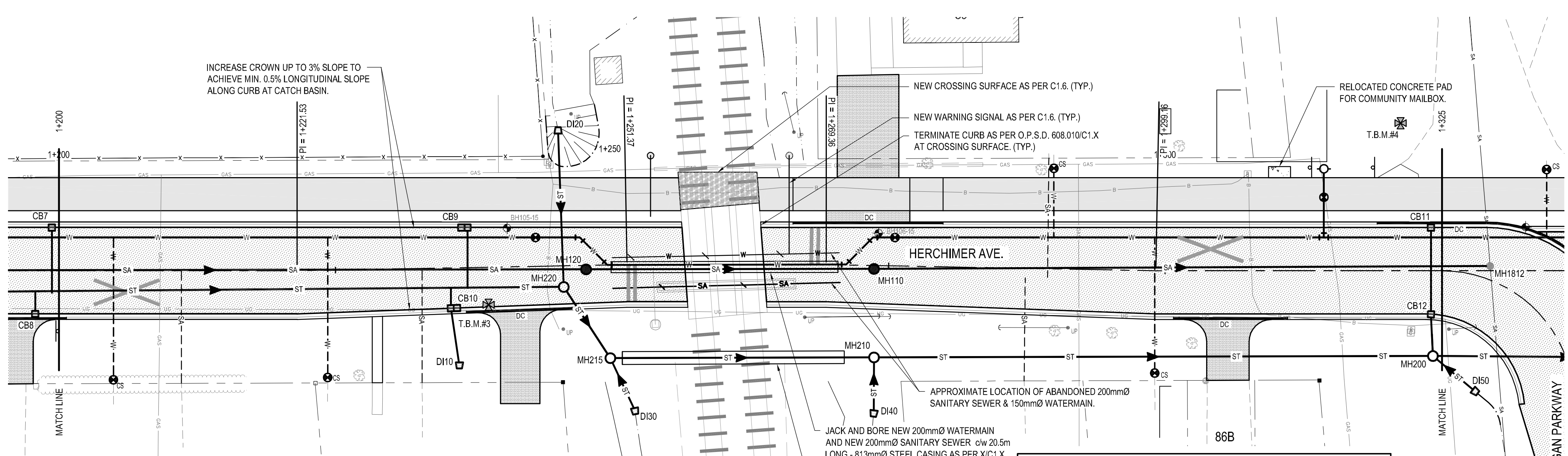

SCHEDULE OF CATCH BASIN

CB No.	STATION	TOP OF GRATE (m)	INVERT (m)	INVERT AT MAIN (m)	SUMP (m)	LEAD (mm)	SLOPE (%)	SIZE (mm)	LEAD LENGTH (m)
CB9	1+237.01	79.69	W 78.41	78.00	77.81	375	7.5%	1450X600	5.4
CB10	1+235.36	79.69	SW 78.49 E 78.41	* 78.31	77.81	300	1.0%, 5.5%	1450X600	5.2, 1.8
CB11	1+324.02	77.29	W 76.41	76.33	75.81	300	1.0%	600X600	7.8
CB12	1+324.02	77.29	E 76.33 W 76.26	76.22	75.66	375	-1.0%	600X600	7.8, 3.3

SCHEDULE OF DITCH INLET

DI No.	STATION	TOP OF GRATE	INVERT	SUMP	LEAD	SLOPE	SIZE	LENGTH
DI10	1+236.05	79.45 HORZ.	NE 78.54	77.94	300	1.0%	600X600	5.2
DI20	1+245.35	78.75 3H:1V	W 77.99	77.29	300	1.0%	1200X600 TYPE 'B'	14.2
DI30	1+252.08	78.85 3H:1V	NE 77.93	77.33	300	2.8%	1200X600 TYPE 'B'	5.3
DI40	1+273.90	78.65 3H:1V	E 77.73	77.13	300	3.0%	1200X600 TYPE 'B'	5.1

VERTICAL CURVE No.3

STA.	ELEVATION
1+200	80.56
1+205	80.35
1+210	80.18
1+215	80.03
1+220	79.92
1+225	79.83
1+230	79.78
1+235	79.76
1+235.86	79.759 (LP)
1+240	79.77
1+245	79.81
1+250	79.88
1+255	79.99
1+255.86	80.009

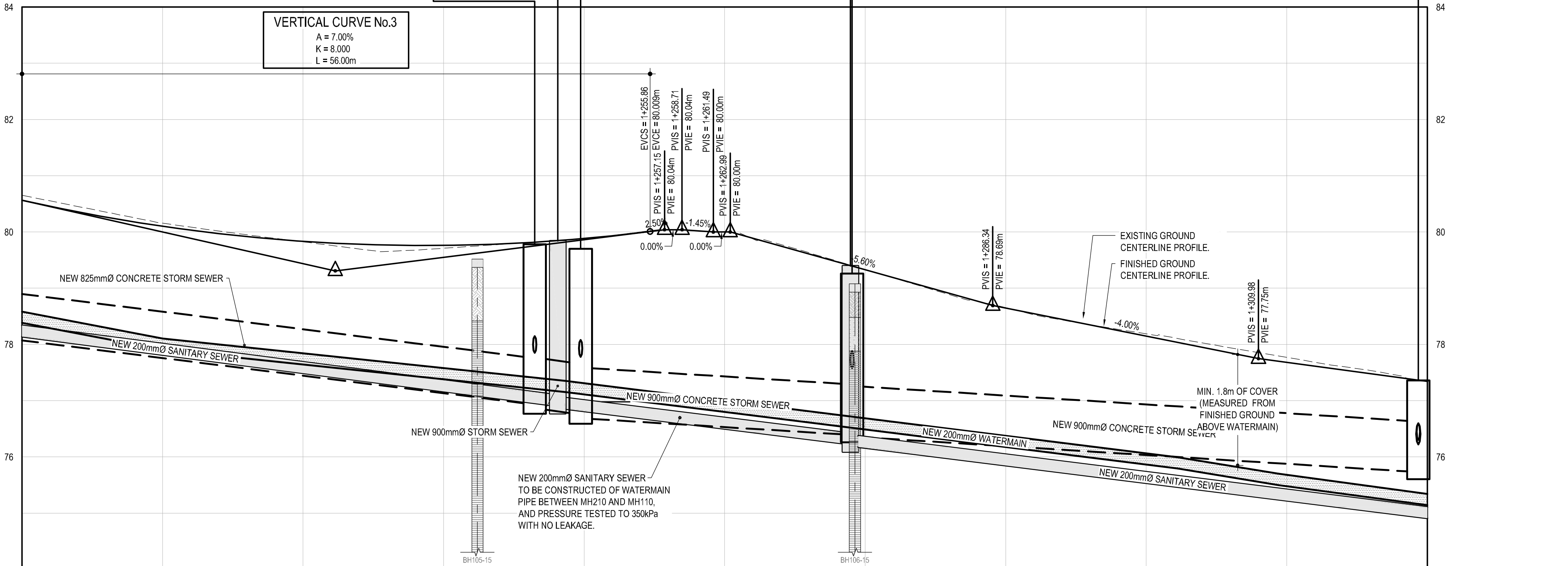

STATION	CENTERLINE GRADE FINISHED	TOP OF WATERMAIN	SANITARY SEWER INVERT	STORM SEWER INVERT	STATION	CENTERLINE GRADE FINISHED	TOP OF WATERMAIN	SANITARY SEWER INVERT	STORM SEWER INVERT
1+200	80.56	78.58	76.87	76.50	1+275	79.33	76.69	76.22	76.36
1+205	80.35				1+280	79.33	76.69	76.22	76.36
1+210	80.18				1+285	79.33	76.69	76.22	76.36
1+215	80.03				1+290	79.33	76.69	76.22	76.36
1+220	79.92				1+295	79.33	76.69	76.22	76.36
1+225	79.83				1+300	79.33	76.69	76.22	76.36
1+230	79.78				1+305	79.33	76.69	76.22	76.36
1+235	79.76				1+310	79.33	76.69	76.22	76.36
1+235.86	79.759 (LP)				1+315	79.33	76.69	76.22	76.36
1+240	79.77				1+320	79.33	76.69	76.22	76.36
1+245	79.81				1+325	79.33	76.69	76.22	76.36
1+250	79.88								
1+255	79.99								
1+255.86	80.009								

- NOTES:**
- CONTRACTOR TO VERIFY LOCATION OF ALL BURIED SERVICES PRIOR TO START OF CONSTRUCTION
 - TOPOGRAPHIC INFORMATION PROVIDED BY THE CITY OF BELLEVILLE AND BY LESLIE M. HIGGINSON SURVEYING LTD.
 - ELEVATIONS SHOWN ON THIS PLAN ARE GEODETIC AND HAVE BEEN DERIVED BY GPS.
 - ALL DISTURBED AREAS TO BE REINSTATED USING 150mm OF TOPSOIL AND SEED UNLESS OTHERWISE NOTED.

LEGEND:

- EXISTING PROPERTY LINE
- NEW EDGE OF PAVEMENT
- EXISTING EDGE OF PAVEMENT
- NEW CURB
- NEW DEPRESS CURB
- EXISTING CURB
- NEW EDGE OF GRANULARS
- EXISTING BOTTOM OF SLOPE
- EXISTING TOP OF SLOPE
- EXISTING FENCE
- NEW SANITARY SEWER
- EXISTING SANITARY SEWER
- NEW SANITARY SERVICE
- NEW STORM SEWER
- EXISTING STORM SEWER
- NEW STORM SERVICE
- NEW PERFORATED PIPE
- NEW WATERMAIN
- EXISTING WATERMAIN
- NEW WATER SERVICE
- NEW SEWER INSULATION AS PER 3/C1.12
- NEW SANITARY MANHOLE
- EXISTING SANITARY MANHOLE
- NEW STORM MANHOLE
- EXISTING STORM MANHOLE
- NEW CATCH BASIN MANHOLE
- NEW CATCH BASIN
- EXISTING CATCH BASIN
- NEW HYDRANT
- EXISTING HYDRANT
- NEW VALVE
- EXISTING VALVE
- NEW BLOW-OFF
- EXISTING BELL LINE
- EXISTING GAS LINE
- EXISTING UNDERGROUND SERVICE
- EXISTING OVERHEAD SERVICE
- EXISTING UTILITY POLE
- EXISTING BELL MANHOLE
- EXISTING BELL PEDESTAL
- EXISTING CABLE PEDESTAL
- EXISTING GAS VALVE
- EXISTING BOLLARD
- SITE TEMPORARY BENCH MARK
- BOREHOLE
- NEW PAINT LINES
- NEW SIDEWALK AS PER O.P.S.D. 310.010M/C1.13 OR 310.020M/C1.13
- NEW ASPHALT BIKE PATH AS PER DETAIL 1&2/C1.12
- NEW ASPHALT AS PER DETAIL 1&2/C1.12
- NEW HIGH STRENGTH ASPHALT AS PER DETAIL 11/C1.12
- NEW ASPHALT DRIVEWAY AS PER DETAIL 6/C1.12
- NEW GRANULAR DRIVEWAY AS PER DETAIL 7/C1.12
- NEW STAMPED CONCRETE

BOREHOLE INFORMATION
 REFER TO "GEOTECHNICAL INVESTIGATION REPORT (REF. #4313-001)" BY CAMBIUM INC. FOR ADDITIONAL INFORMATION.

- ASPHALT
- FILL
- SILT
- TILL
- LIMESTONE

CLIENT: BELLEVILLE
 CLIENT REF. #: BELLEVILLE
 PROJECT: HERCHIMER AVE. RECONSTRUCTION

DISCLAIMER: THIS DRAWING AND DESIGN IS COPYRIGHT PROTECTED WHICH SHALL NOT BE USED, REPRODUCED OR FILED WITHOUT WRITTEN PERMISSION BY WSP. THE CONTRACTOR SHALL CHECK AND VERIFY ALL DIMENSIONS AND UTILITY LOCATIONS AND REPORT ALL ERRORS AND OMISSIONS PRIOR TO COMMENCING WORK. THIS DRAWING IS NOT TO BE SCALED.

ISSUED FOR - REVISION:

NO.	DATE	DESCRIPTION
3	2016/06/24	ISSUED FOR 90% DESIGN REVIEW
2	2016/03/16	ISSUED FOR 60% DESIGN REVIEW
1	2015/09/10	ISSUED FOR 30% DESIGN REVIEW

PROJECT NO.: 151-05368-00
DATE: 2016/06/24

ORIGINAL SCALE: H:1:250, V:1:50
 IF THIS BAR IS NOT 25mm LONG, ADJUST YOUR PLOTTING SCALE.

DESIGNED BY: F.L.
DRAWN BY: K.B.W.
CHECKED BY: J.E.

DISCIPLINE: CIVIL

TITLE: PLAN AND PROFILE OF HERCHIMER AVE. FROM STA 1+325 TO STA 1+425

SHEET NUMBER: C1.4
ISSUE: ISSUED FOR 90% DESIGN REVIEW
DATE OF: 2016/06/24
REV #: 0

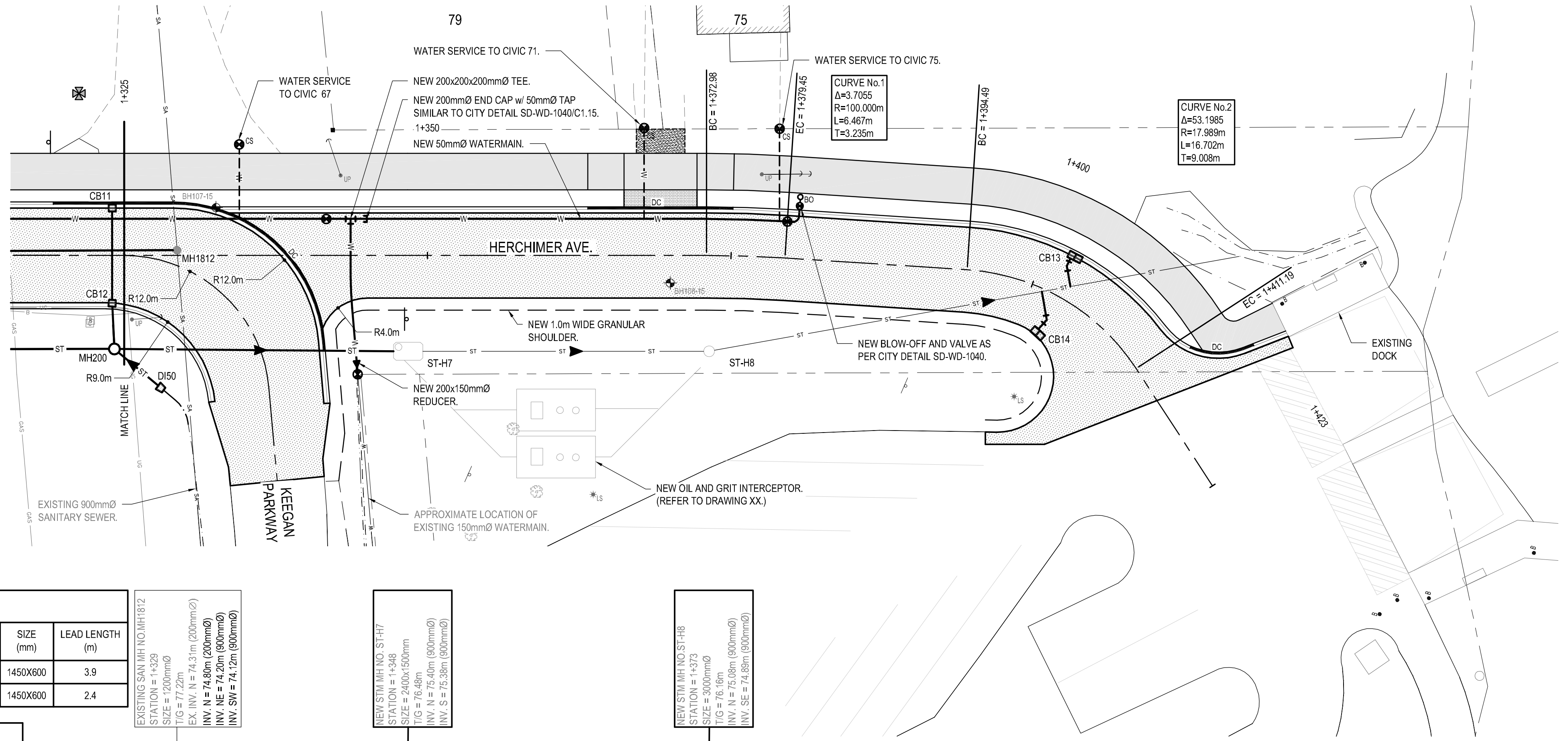

SCHEDULE OF CATCH BASIN

CB No.	STATION	TOP OF GRATE (m)	INVERT (m)	INVERT AT MAIN (m)	SUMP (m)	LEAD (m)	SLOPE (%)	SIZE (mm)	LEAD LENGTH (m)
CB13	1+401.84	75.89	W 75.06	75.03	74.46	375	1.3%	1450X600	3.9
CB14	1+402.00	75.89	SE 75.06	75.03	74.46	375	0.9%	1450X600	2.4

SCHEDULE OF DITCH INLET

DI No.	STATION	TOP OF GRATE	INVERT	SUMP	LEAD	SLOPE	SIZE	LENGTH
DI50	1+328.03	76.60 3H:1V	N 76.35	75.75	300	1.0%	1200X600 TYPE 'B'	5.0

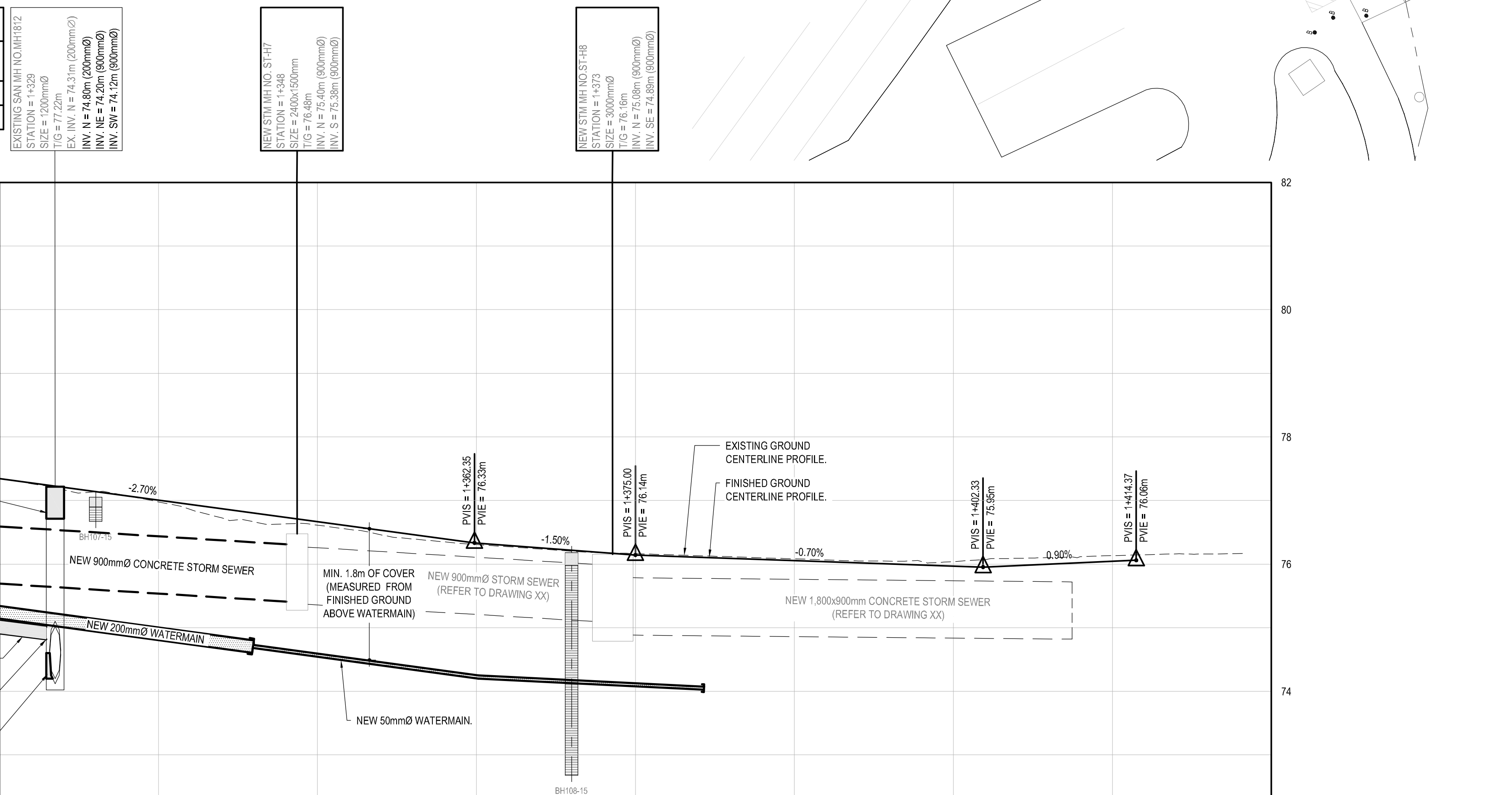

STATION	1+325	1+350	1+375	1+400	1+425	STATION	
CENTERLINE GRADE	FINISHED EXISTING 71.34	77.35	76.67	76.61	75.97	FINISHED EXISTING 76.04	
TOP OF WATERMAIN	75.34	74.59	74.13	74.04	74.04	74.04	
SANITARY SEWER INVERT	76.19	NEW 55.69m 200mmØ SANITARY SEWER @ 2.50%	74.80	74.04	74.04	74.04	
STORM SEWER INVERT	75.70	NEW 24.20m 900mmØ STORM SEWER @ 1.25%	75.38	NEW 24.79m 900mmØ STORM SEWER @ 1.19% (REFER TO DRAWING XX)	74.09	NEW 44.34m 1,800x900mm STORM SEWER @ 0.15% (REFER TO DRAWING XX)	74.02

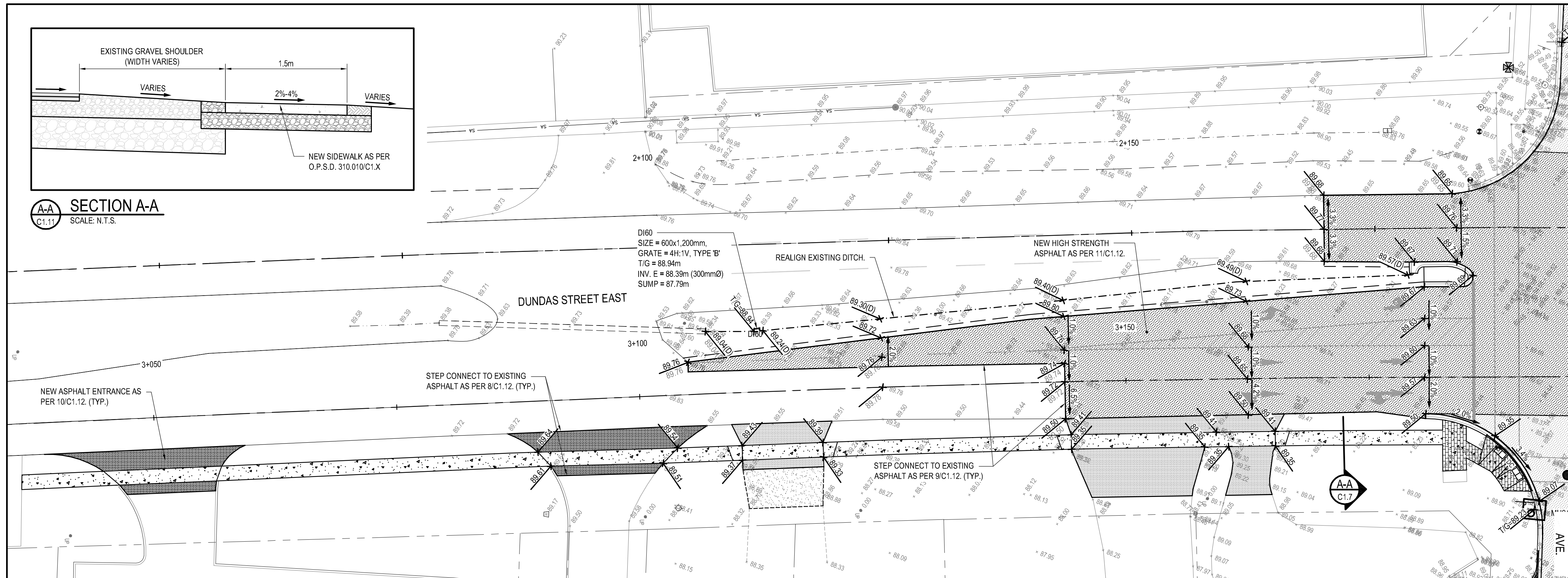

GRADING - DUNDAS STREET EAST
SCALE: 1:250

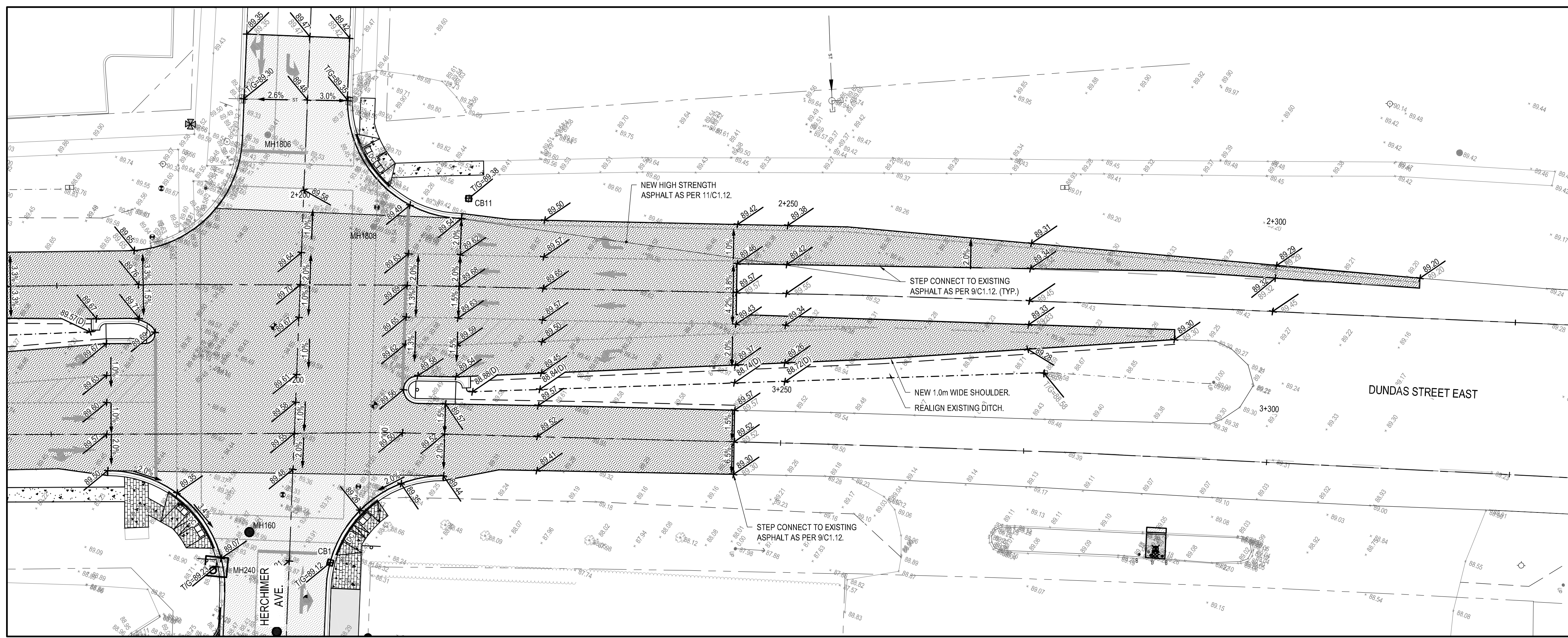

GRADING - DUNDAS STREET EAST
SCALE: 1:250

NOTES:

- CONTRACTOR TO VERIFY LOCATION OF ALL BURIED SERVICES PRIOR TO START OF CONSTRUCTION
- TOPOGRAPHIC INFORMATION PROVIDED BY THE CITY OF BELLEVILLE AND BY LESLIE M. HIGGINSON SURVEYING LTD.
- ELEVATIONS SHOWN ON THIS PLAN ARE GEODETIC AND HAVE BEEN DERIVED BY GPS.
- ALL DISTURBED AREAS TO BE REINSTATED USING 150mm OF TOPSOIL AND SEED UNLESS OTHERWISE NOTED.

LEGEND:

- EXISTING PROPERTY LINE
- NEW EDGE OF PAVEMENT
- EXISTING EDGE OF PAVEMENT
- NEW CURB
- NEW DEPRESS CURB
- EXISTING CURB
- NEW EDGE OF GRANULARS
- EXISTING BOTTOM OF SLOPE
- EXISTING TOP OF SLOPE
- EXISTING FENCE
- NEW SANITARY MANHOLE
- EXISTING SANITARY MANHOLE
- NEW STORM MANHOLE
- EXISTING STORM MANHOLE
- NEW CATCH BASIN MANHOLE
- NEW CATCH BASIN
- EXISTING CATCH BASIN
- NEW HYDRANT
- EXISTING HYDRANT
- NEW VALVE
- EXISTING VALVE
- FINISHED GROUND ELEVATION
- FINISHED TOP OF CONCRETE ELEVATION
- FINISHED TOP OF GRATE ELEVATION
- EXISTING ELEVATION
- EXISTING OVERHEAD SERVICE
- EXISTING UTILITY POLE
- EXISTING BELL MANHOLE
- EXISTING BELL PEDESTAL
- EXISTING CABLE PEDESTAL
- EXISTING GAS VALVE
- SITE TEMPORARY BENCH MARK
- NEW PAINT LINES
- NEW SIDEWALK AS PER O.P.S.D. 310.010M/C1.13
- NEW ASPHALT BIKE PATH AS PER DETAIL 1&2/C1.12
- NEW ASPHALT AS PER DETAIL 1&2/C1.12
- NEW HIGH STRENGTH ASPHALT AS PER DETAIL 11/C1.12
- NEW HEAVY DUTY ASPHALT AS PER DETAIL 10/C1.12
- NEW ASPHALT DRIVEWAY AS PER DETAIL 6/C1.12
- NEW GRANULAR DRIVEWAY AS PER DETAIL 7/C1.12
- NEW STAMPED CONCRETE

CLIENT: BELLEVILLE
PROJECT: HERCHIMER AVE. RECONSTRUCTION

DISCLAIMER: THIS DRAWING AND DESIGN IS COPYRIGHT PROTECTED WHICH SHALL NOT BE USED, REPRODUCED OR FURTHER DISTRIBUTED WITHOUT WRITTEN PERMISSION BY WSP. THE CONTRACTOR SHALL CHECK AND VERIFY ALL DIMENSIONS AND UTILITY LOCATIONS AND REPORT ALL ERRORS AND OMISSIONS PRIOR TO COMMENCING WORK. THIS DRAWING IS NOT TO BE SCALED.

ISSUED FOR - REVISION:

IS	RE	DATE	DESCRIPTION
3		2016/06/24	ISSUED FOR 90% DESIGN REVIEW
2		2016/03/16	ISSUED FOR 60% DESIGN REVIEW
1		2015/09/10	ISSUED FOR 30% DESIGN REVIEW

PROJECT NO: 151-05368-00
DATE: 2016/06/24

ORIGINAL SCALE: 1:250
DESIGNED BY: F.L.
DRAWN BY: K.B.W.
CHECKED BY: J.E.

DISCIPLINE: CIVIL

TITLE: GRADING - DUNDAS STREET EAST

SHEET NUMBER: C1.7

ISSUE: ISSUED FOR 90% DESIGN REVIEW
DATE OF: 2016/06/24

REV # 0

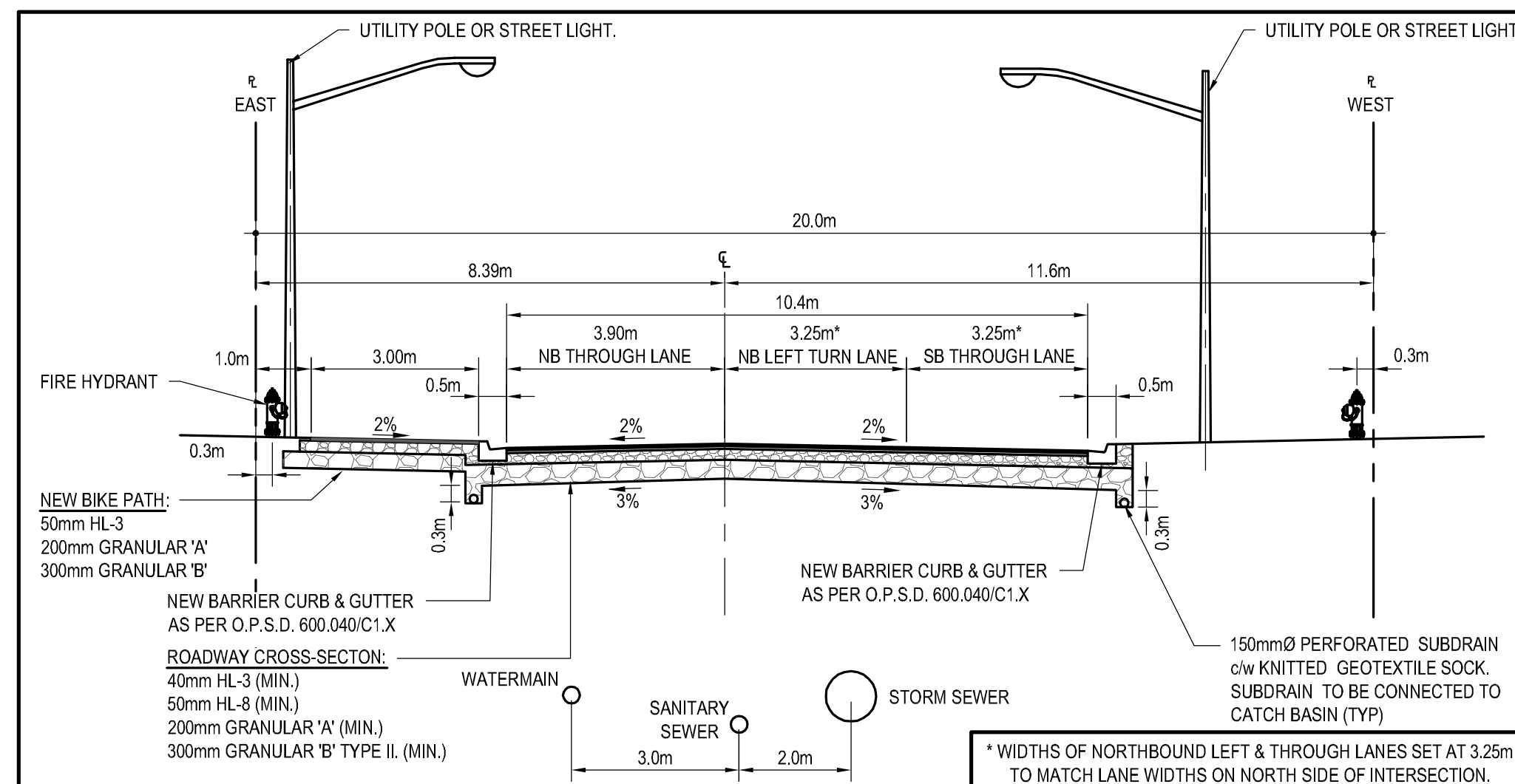

1 TYPICAL ROAD CROSS-SECTION DETAIL (@ DUNDAS STREET EAST INTERSECTION)
SCALE: 1:100

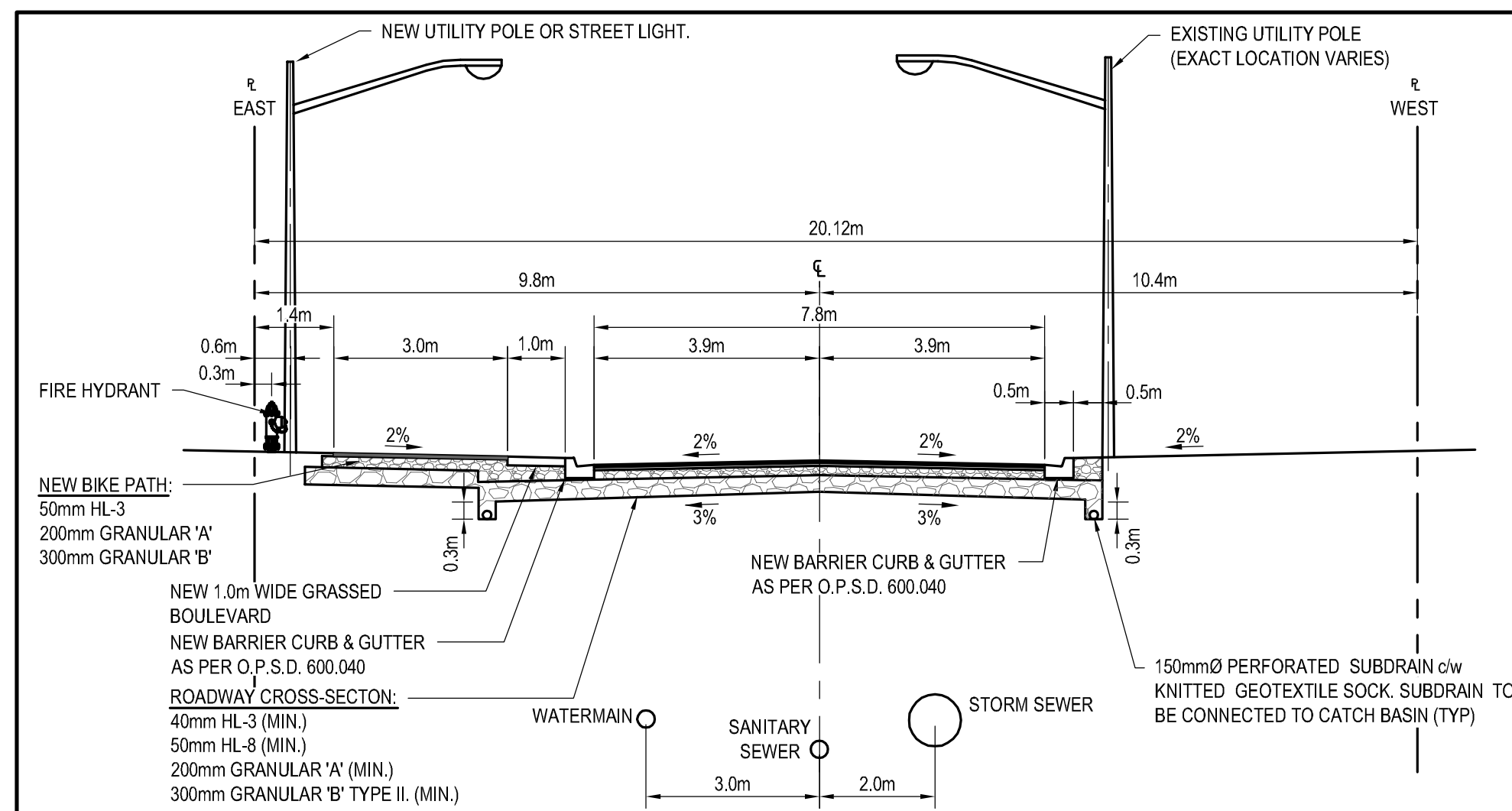

2 TYPICAL ROAD CROSS-SECTION DETAIL
SCALE: 1:100

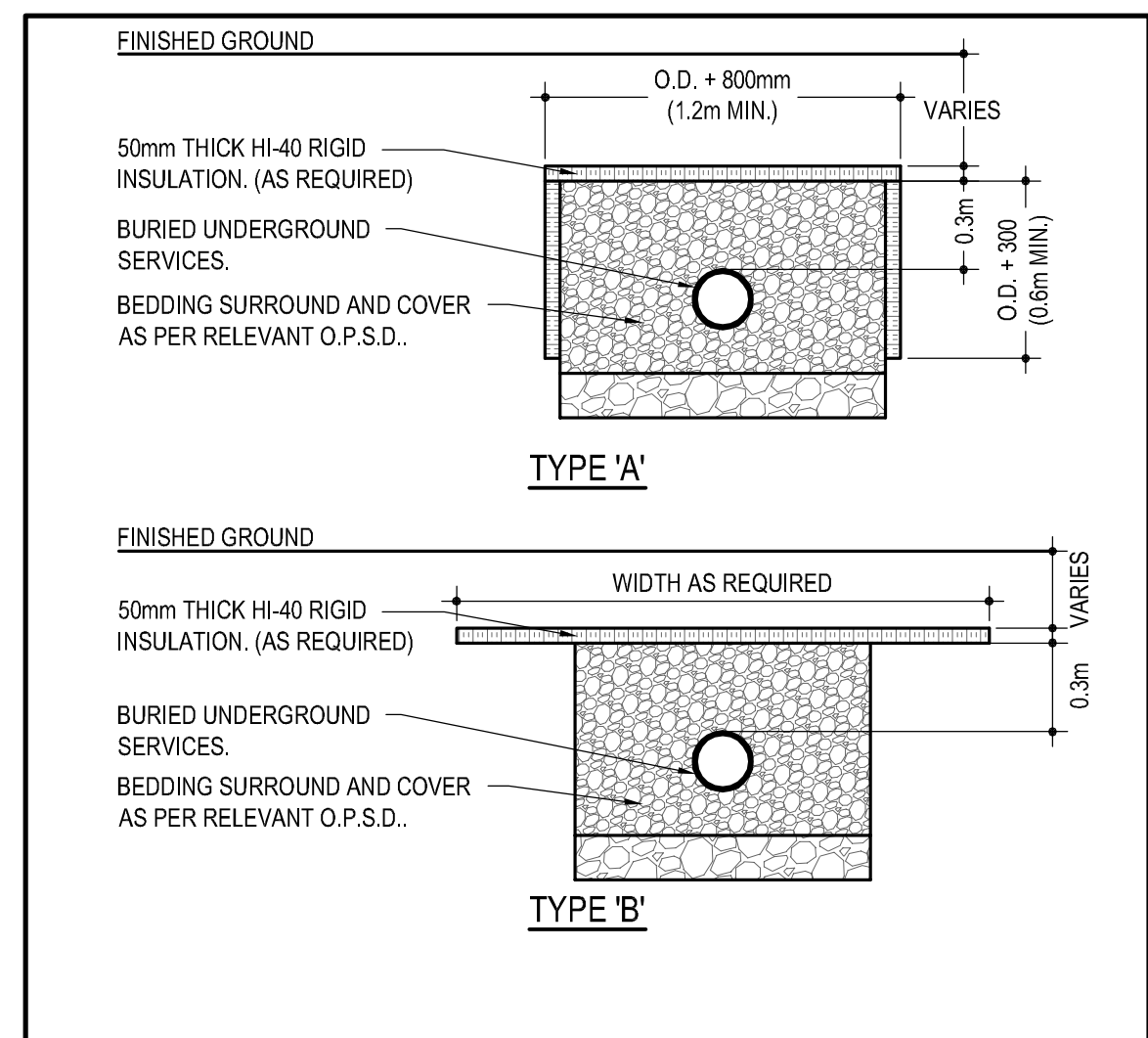

3 TYPICAL FROST PROTECTION DETAIL
SCALE: N.T.S.

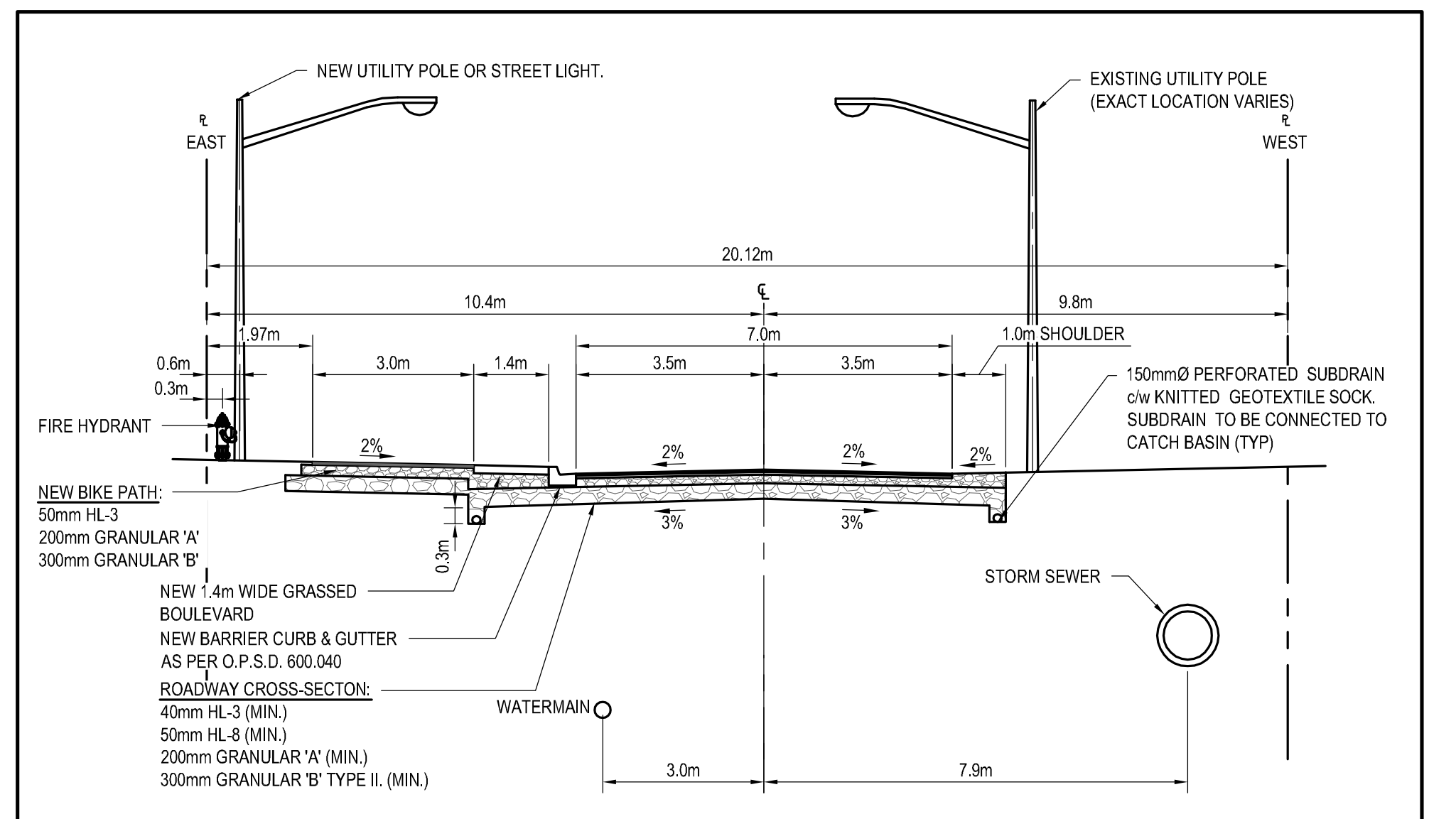

4 TYPICAL ROAD CROSS-SECTION DETAIL (STA 1+338.5 TO STA 1+414.4)
SCALE: 1:100

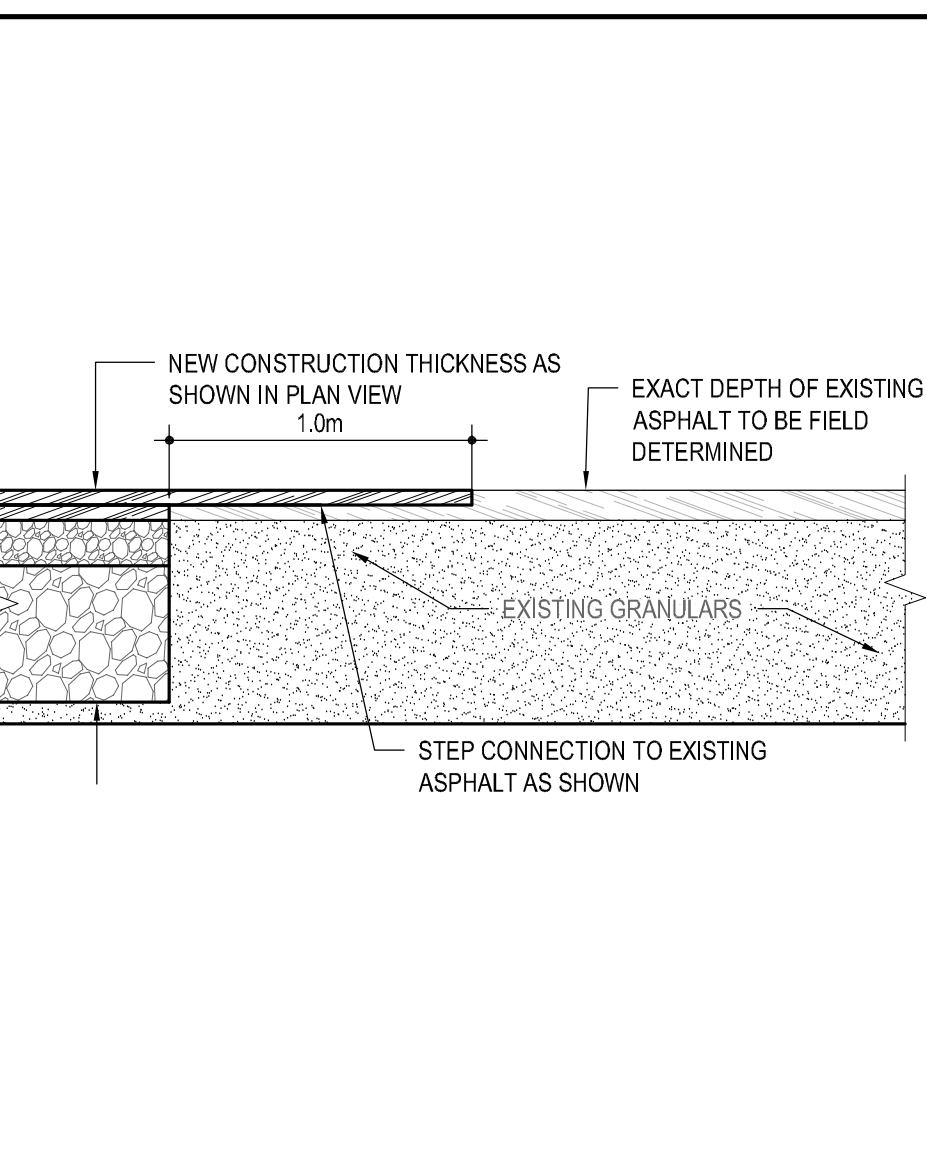

5 TYPICAL STEP CONNECTION DETAIL
SCALE: 1:25

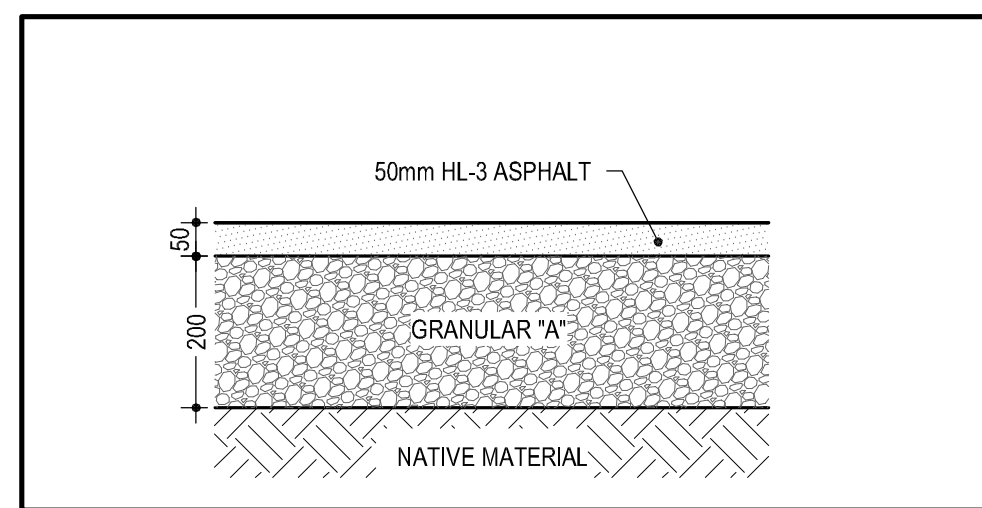

6 ASPHALT DRIVEWAY REINSTATEMENT
SCALE: N.T.S.

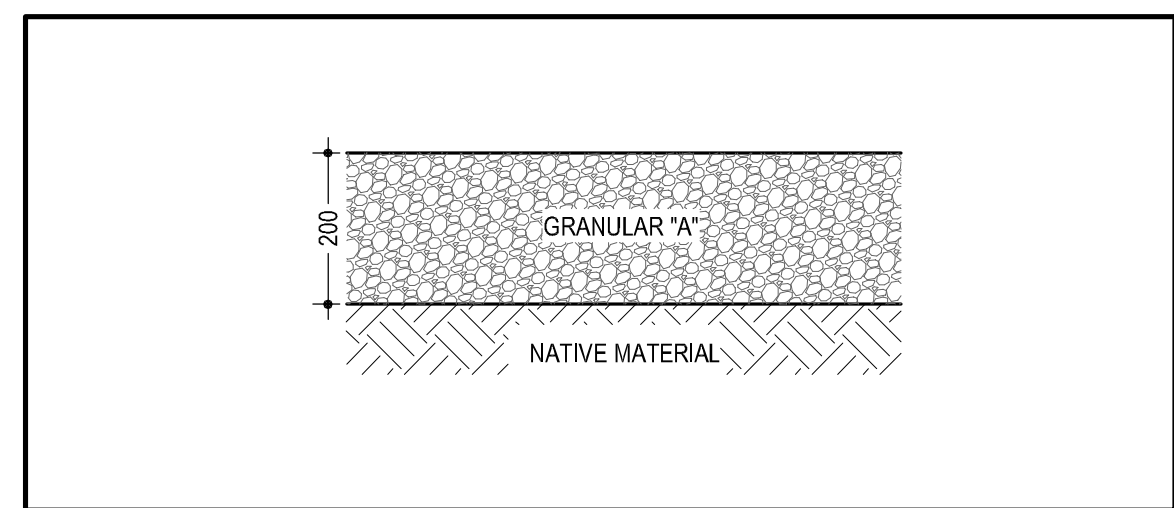

7 GRANULAR DRIVEWAY REINSTATEMENT
SCALE: N.T.S.

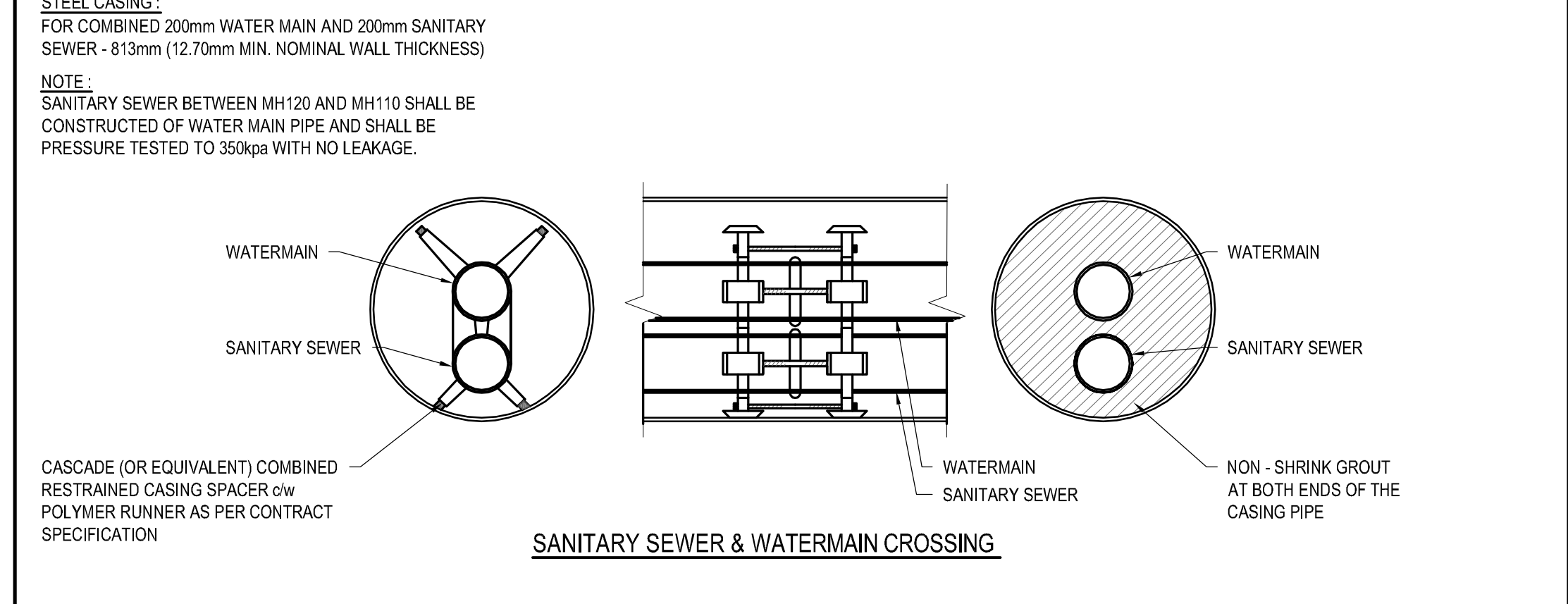
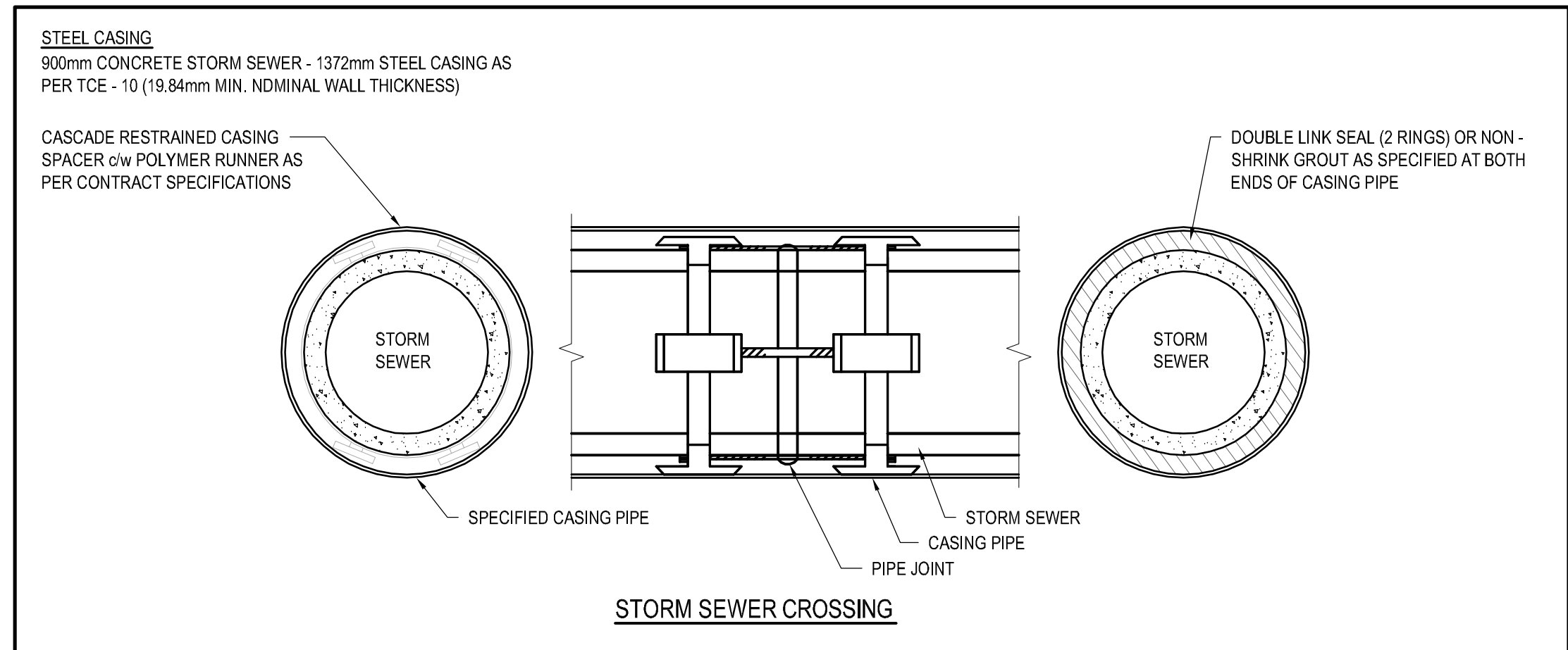

12 TYPICAL JACK AND BORE RAIL CROSSING DETAIL
SCALE: 1:30

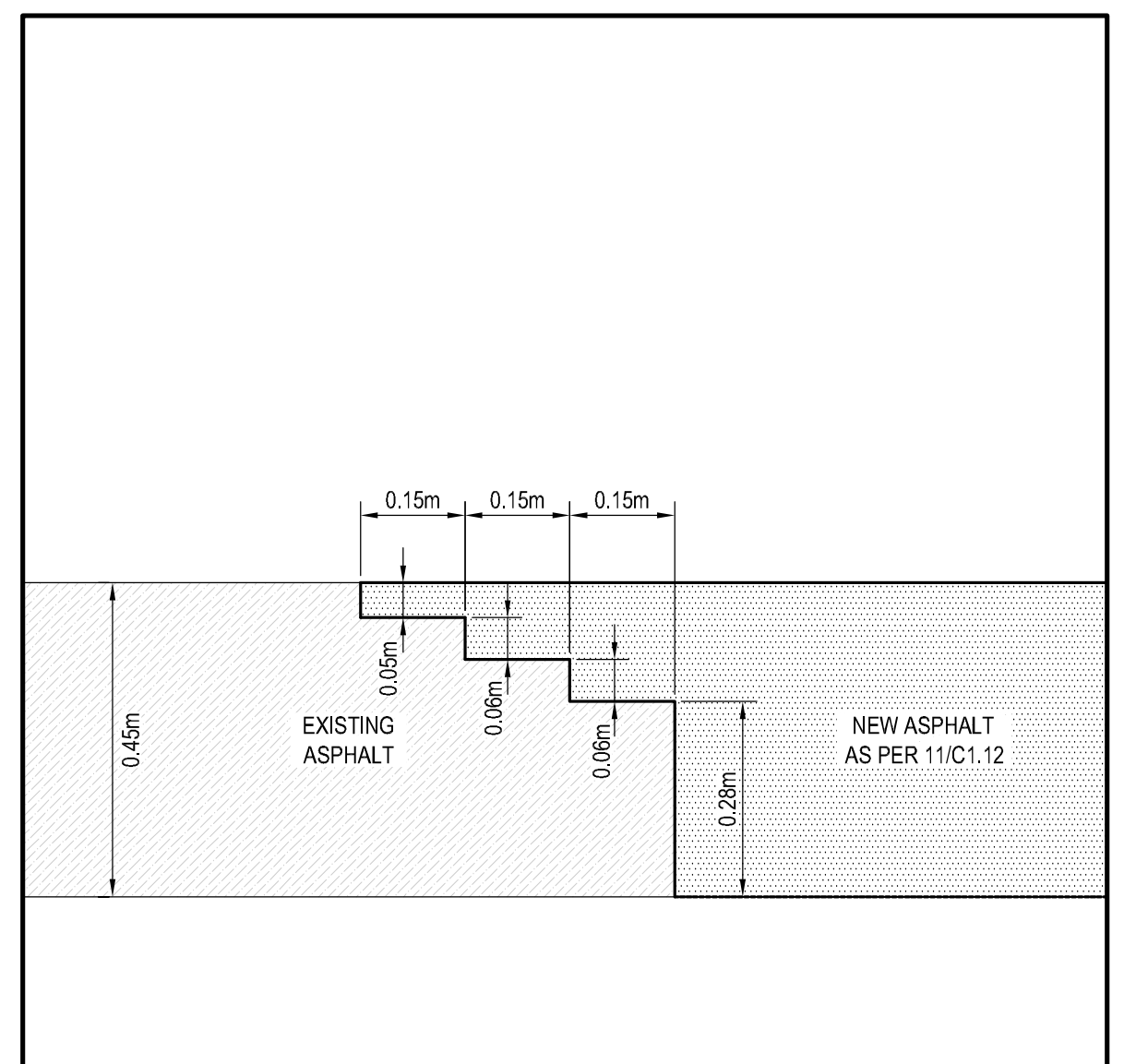

9 STEPPING DETAIL FOR DUNDAS STREET
SCALE: N.T.S.

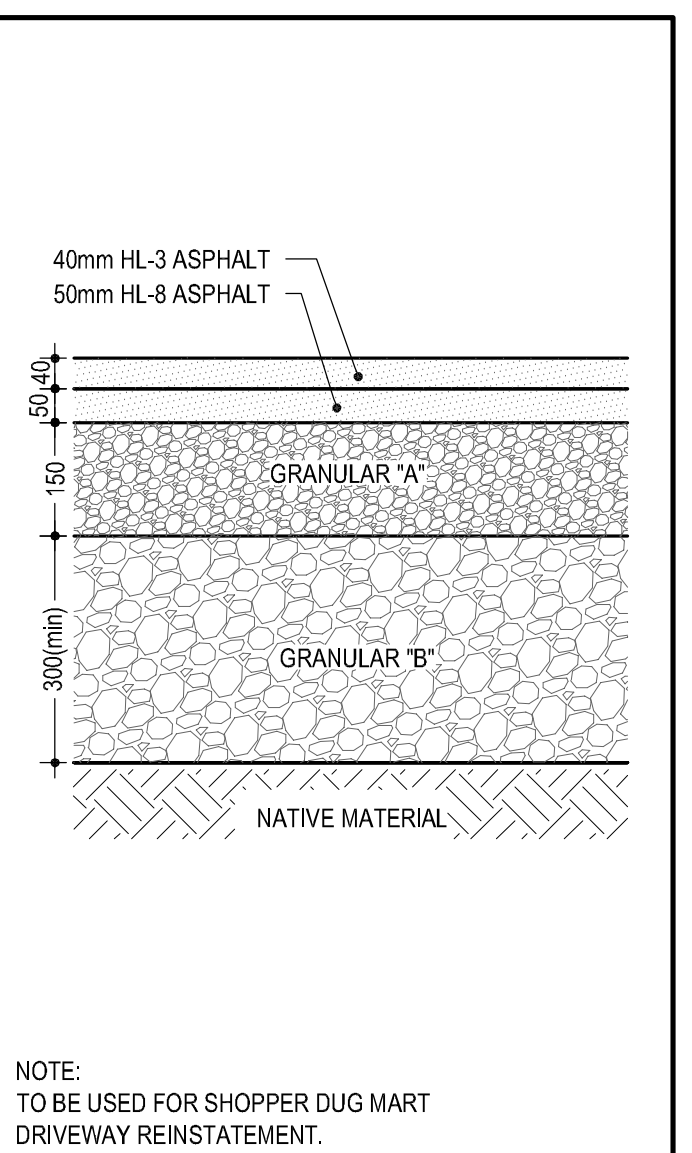

10 HEAVY DUTY ASPHALT
SCALE: N.T.S.

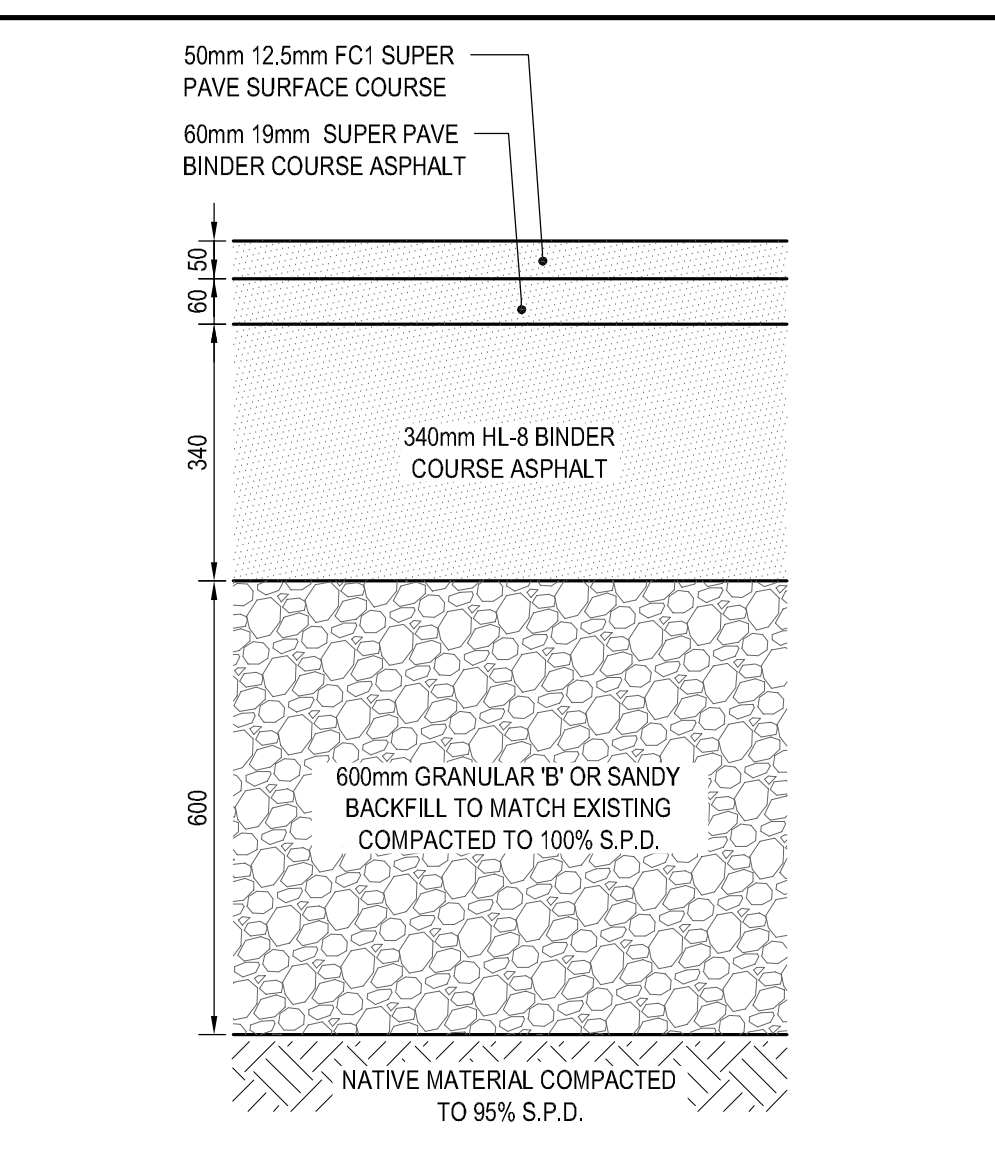

11 HIGH STRENGTH ASPHALT(DUNDAS ST.E.)
SCALE: N.T.S.



HERCHIMER AVE. RECONSTRUCTION

DISCLAIMER: THIS DRAWING AND DESIGN IS COPYRIGHT PROTECTED WHICH SHALL NOT BE USED, REPRODUCED OR FILED WITHOUT WRITTEN PERMISSION BY WSP. THE CONTRACTOR SHALL CHECK AND VERIFY ALL DIMENSIONS AND UTILITY LOCATIONS AND REPORT ALL ERRORS AND OMISSIONS PRIOR TO COMMENCING WORK. THIS DRAWING IS NOT TO BE SCALED.

IS	RE	DATE	DESCRIPTION
3		2016/06/24	ISSUED FOR 90% DESIGN REVIEW
2		2016/03/18	ISSUED FOR 60% DESIGN REVIEW
1		2015/08/10	ISSUED FOR 30% DESIGN REVIEW

PROJECT NO.	DATE
151-05368-00	2016/06/24

DISCIPLINE	TITLE
CIVIL	DETAILS

SHEET NUMBER	ISSUE	DATE OF
C1.12	ISSUED FOR 90% DESIGN REVIEW	2016/06/24